

SKORPION Trapped Key Interlocking with Key Exchange

KEY EXCHANGE DIE CAST METAL ORDERING:

M-KE-NS4

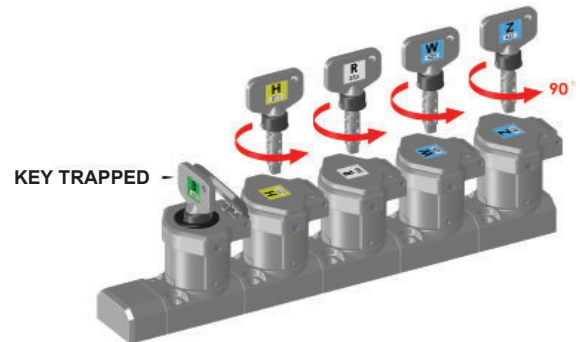

Sales Number	KEY EXCHANGE - DIE CAST METAL (Mirror Finish)
M-KE-NS2	2 Key (First key trapped - 1 released non-sequential)
M-KE-NS3	3 Key (First key trapped - 2 released non-sequential)
M-KE-NS4	4 Key (First key trapped - 3 released non-sequential)
M-KE-NS5	5 Key (First key trapped - 4 released non-sequential)

BOLT INTERLOCKS (not suitable for guard access) DIE CAST METAL ORDERING:

M-BS



Sales Number	BOLT INTERLOCK SINGLE KEY DIE CAST METAL (Mirror Finish)
M-BS	Key trapped - bolt retracted

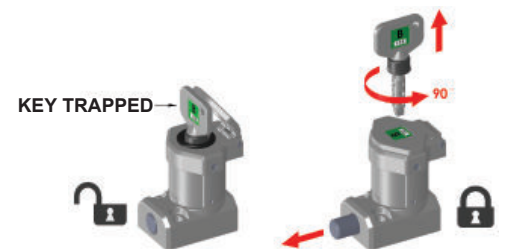

M-BD-11

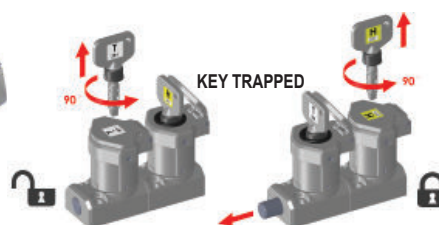

Sales Number	BOLT INTERLOCK DUAL KEY DIE CAST METAL (Mirror Finish)
M-BD-11	2 keys - 1 key trapped 1 key free - bolt retracted



Sales Number	BOLT INTERLOCK DUAL KEY DIE CAST METAL (Mirror Finish)
M-BD-20	2 keys trapped - bolt retracted

SKORPION Trapped Key Interlocking with Key Exchange

HANDLE INTERLOCKS DIE CAST METAL ORDERING:

M-HS

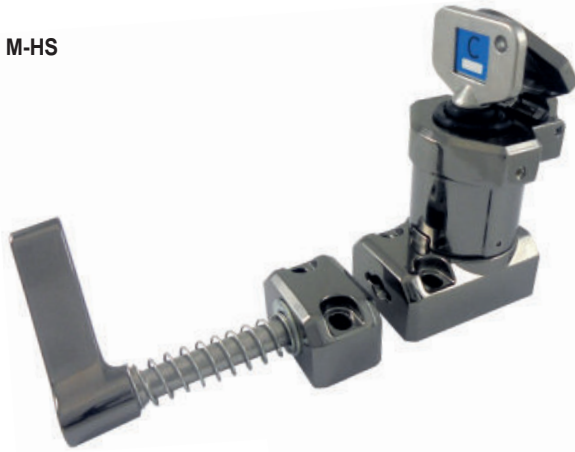

Sales Number	HANDLE INTERLOCK SINGLE KEY DIE CAST METAL (Mirror Finish)
M-HS	Key trapped - actuator unlocked (spring action handle)
M-HS-C	Key trapped - actuator unlocked (chain fixed to handle)

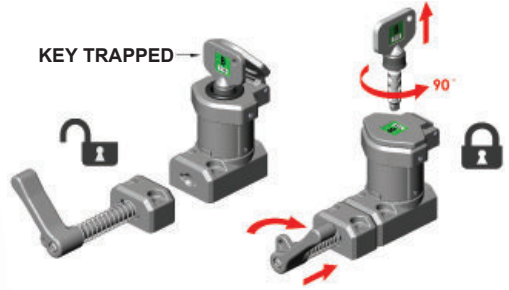

M-HS-C



HANDLE INTERLOCKS (Dual Key) DIE CAST METAL ORDERING:

M-HD-11



Sales Number	HANDLE INTERLOCK DUAL KEY DIE CAST METAL (Mirror Finish)
M-HD-11	2 sequential keys - one key trapped one key free - actuator unlocked (spring action handle)
M-HD-C-11	2 sequential keys - one key trapped one key free - actuator unlocked (chain fixed to handle)

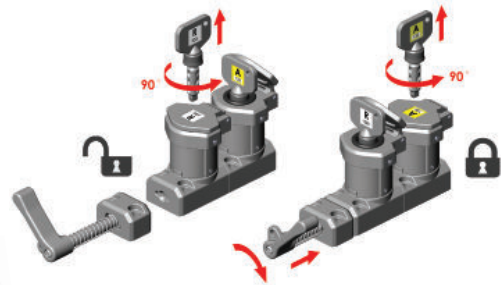

M-HD-C-11



SKORPION Trapped Key Interlocking with Key Exchange

TONGUE INTERLOCKS (Single Key) DIE CAST METAL ORDERING:

M-TS



*See below for Actuator options.

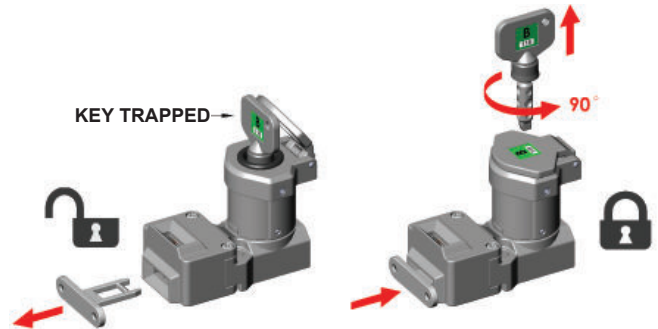

Sales Number	TONGUE INTERLOCK SINGLE KEY	DIE CAST METAL (Mirror Finish)
M-TS	Key trapped - actuator unlocked	

TONGUE INTERLOCKS (Dual Key) DIE CAST METAL ORDERING:

M-TD-11



*See below for Actuator options.

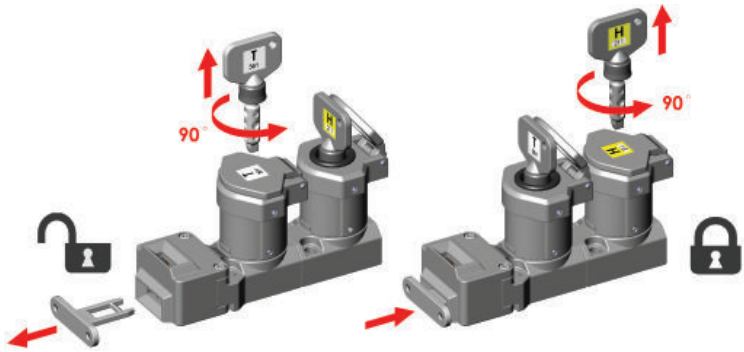

Sales Number	TONGUE INTERLOCK DUAL KEY	DIE CAST METAL (Mirror Finish)
M-TD-11	2 sequential keys - one key trapped one key free - actuator unlocked	

ACTUATORS FOR TONGUE INTERLOCK SWITCHES SELECTION CHART:



SALES NUMBER	ACTUATOR TYPE
140107	A = Standard Actuator Stainless Steel 316
140108	F = Flat Actuator Stainless Steel 316 with Plastic Cover
140110	HF = Heavy Duty Flexible Actuator Stainless Steel 316 and Die Cast
140111	HFH = Heavy Duty Flexible Actuator fully Stainless Steel 316

SKORPION Trapped Key Interlocking with Key Exchange

INTERLOCKING WITH CONTROL ISOLATION DIE CAST METAL ORDERING:

M-TS-CB

Sales Number	TONGUE INTERLOCK SINGLE KEY WITH CONTACT BLOCK DIE CAST METAL (Mirror Finish)
M-TS-CB-22-N	Single Tongue Interlock with 2NC 2NO Contact Block - 1/2" NPT
M-TS-CB-31-N	Single Tongue Interlock with 3NC 1NO Contact Block - 1/2" NPT
M-TS-CB-22-M	Single Tongue Interlock with 2NC 2NO Contact Block - M20
M-TS-CB-31-M	Single Tongue Interlock with 3NC 1NO Contact Block - M20



*See below for Actuator options.

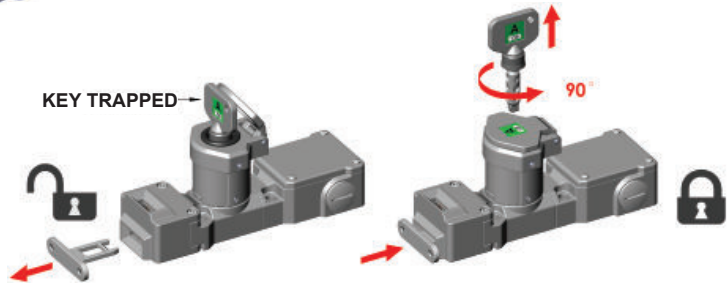

EXPLOSION PROOF INTERLOCKING WITH CONTROL ISOLATION DIE CAST METAL ORDERING:

M-TS-CB EX



Trapped Key with ATEX EExd IIC T6 certified explosion proof contact blocks.

The explosion proof contact blocks conform to European harmonized standard EN60079-0 and EN60079-1 and can be used in European Zone 1, 2, 21, 22 environments. (Gas and Dust). Adheres to the latest standard ISO13850, Designed for use in oil, petro-chemical, pharmaceutical, food processing and packaging applications where the potential for explosive atmospheres are present.

Exd IIC T6 (-20 ≤ Ta ≤ +60C)

Ex tb IIIC T85C (-20 ≤ Ta ≤ +60C) Db



*See below for Actuator options.

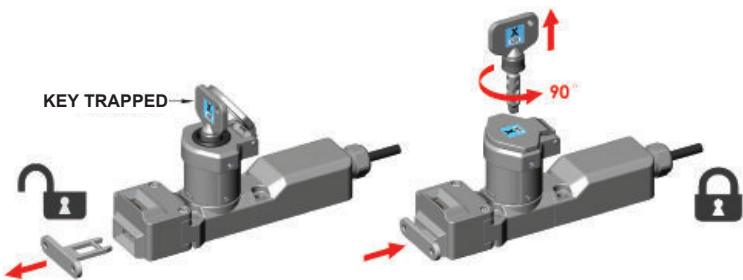

Sales Number	TONGUE INTERLOCK SINGLE KEY WITH EXPLOSION PROOF CONTACT BLOCK DIE CAST METAL (Mirror Finish)
M-TS-CB-22-EX	Single Tongue Interlock with 2NC 2NO Pre-wired EX Block
M-TS-CB-11-EX	Single Tongue Interlock with 1NC 1NO Pre-wired EX Block

ACTUATORS FOR TONGUE INTERLOCK SWITCHES SELECTION CHART:



SALES NUMBER	ACTUATOR TYPE
140107	A = Standard Actuator Stainless Steel 316
140108	F = Flat Actuator Stainless Steel 316 with Plastic Cover
140110	HF = Heavy Duty Flexible Actuator Stainless Steel 316 and Die Cast
140111	HFH = Heavy Duty Flexible Actuator fully Stainless Steel 316