

Micro Installation Beacons - 230/231/232

Size comparison Micro/Mini



Signalisation index

Optical	
LED Permanent Light	2
Xenon Flashing Light	4

Your benefits

Despite their size, micro installation beacons from the 230 / 231 / 232 range will provide good all-round visibility. The range includes control panel indicator lights.

- The industry standard for control panels
- Easy to install, even where space is restricted

Typical applications

Signalling faults and statuses

- On small machines and equipment
- In building technology

Installation options

- M22 single-hole mounting including nut
- M20 for direct installation, in safety switches, for example

Features

- Available with a permanent light
- Powerful xenon flash light for increased visibility





Mainly sideways illumination



The LED Installation Beacon 230 can for example be used in applications with cable-operated switches or limit switch devices

i TECHNICAL SPECIFICATIONS/ORDER SPECIFICATIONS:

Dimensions (Ø x Height):	29 mm x 32 mm (Protrusion from panel)			
Housing:	PC/ABS-Blend			
Lens:	PC, transparent			
Connection:	2 wires, c. 115 mm long			
Fixing:	Installation mounting for Ø 20.5 mm (M20 x 1.5 mm)			
Life duration:	Up to 100,000 hrs			
Seal included in assembly.				

Voltage:	12 V DC	24 V DC	115 V AC	230 V AC
Current consumption:	80 mA	45 mA	15 mA	20 mA
red	230 100 54	230 100 55	230 100 67	230 100 68
yellow	230 300 54	230 300 55	230 300 67	230 300 68
clear	-	230 400 55	-	-

Further colours on request.

1 2 3 TECHNICAL DIAGRAM:

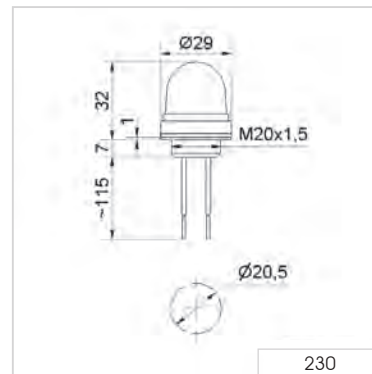

Signalisation index	
LED Permanent Light	2













Mainly sideways illumination

i TECHNICAL SPECIFICATIONS/ORDER SPECIFICATIONS:

Dimensions (Ø x Height): 29 mm x 32 mm (Protrusion from panel)
Housing: PC/ABS-Blend
Lens: PC, transparent
Connection: 2 wires, c. 105 mm long
Fixing: Installation mounting for Ø 22.5 mm (M22 x 1.5 mm)
Life duration: Up to 100,000 hrs
 Nut and seal included in assembly.

	12 V DC	24 V DC	115 V AC	230 V AC
Current consumption:	80 mA	45 mA	15 mA	20 mA
red	231 100 54	231 100 55	231 100 67	231 100 68
green	231 200 54	231 200 55	231 200 67	231 200 68
yellow	231 300 54	231 300 55	231 300 67	231 300 68
clear	231 400 54	231 400 55	231 400 67	231 400 68
blue	231 500 54	231 500 55	231 500 67	231 500 68

TECHNICAL DIAGRAM:

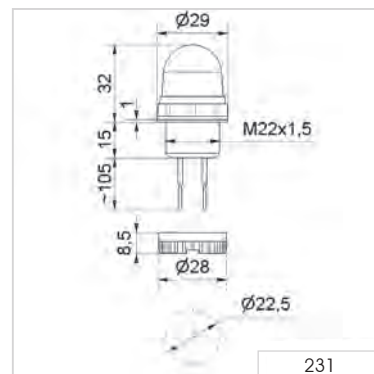

Signalisation index

LED Permanent Light 2



i TECHNICAL SPECIFICATIONS/ORDER SPECIFICATIONS:

Dimensions (Ø x Height): 29 mm x 32 mm (Protrusion from panel)
Housing: PC/ABS-Blend
Lens: PC, transparent
Connection: 2 wires, c. 600 mm long
Fixing: Installation mounting for Ø 22.5 mm (M22 x 1.5 mm) with anti-twist device
Flash frequency: 1.5 Hz
Flash energy: 1 Ws
Life duration: 4 x 10⁶ flashes
 Nut and seal included in assembly.

Voltage:	24 V AC/DC (10-100 V DC) (20-72 V AC)	115 V AC	230 V AC
Current consumption:	140 mA	30 mA	20 mA
red	232 100 55	232 100 67	232 100 68
yellow	232 300 55	232 300 67	232 300 68

TECHNICAL DIAGRAM:

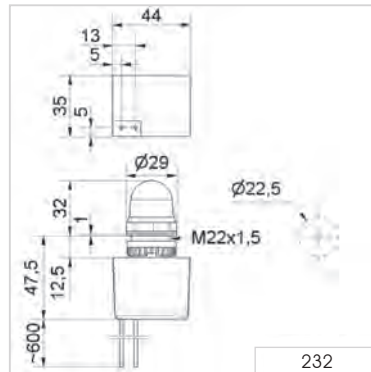

Signalisation index

Xenon Flashing Light 4

CE EAC 54g IP65 +50°C -20°C 1 24 V Ws PLC



Mini Installation Beacons - 239

Size comparison Mini 239/Mini



Signalisation index

Signalisation index	
Optical	
LED Permanent Light (multicolour)	3

Your benefits

WERMA's 239 mini installation beacon is perfect for use on machinery, and control panels. The colours can be set quite simply by means of binary inputs.

- Up to five different colours with just one light
- Low lens, where space is restricted
- Raised lens for best visibility also from the side

Typical applications

Signalling faults and statuses

- On control consoles of machinery
- In machine housings
- On control panels



Installation options

- M22 single-hole mounting

Features

- Bit-encoded actuation allows the three basic colours green, yellow and red to be displayed using just two PLC outputs. With a third output, white and blue can also be activated.
- With Spec. V 3.0, the special AS interface version is suitable for addressing (A/B mode) up to 62 modules – without an external power supply





LED Installation Beacon (Multicolour)



LED Installation Beacon (Multicolour) with raised lens



Five colours in one beacon: red, yellow, green, white and blue

i TECHNICAL SPECIFICATIONS/ORDER SPECIFICATIONS:

Dimensions (Ø x Height):	50 mm x 22 mm (Protrusion from panel) 50 mm x 31 mm (Protrusion from panel)
Housing:	PC/ABS-Blend, black
Lens:	PC, transparent
Fixing:	Installation mounting for Ø 22.5 mm (M22 x 1.5 mm)
Connection:	Screw terminal max. 0.5 mm ² (239 480 55) Push In max. 1.5 mm ² (239 482 55)
Colour options:	Red, yellow, green, white, blue (multicolour)
Life duration:	Up to 50,000 hrs
Nut and seal included in assembly.	
Voltage:	24 V DC
Current consumption:	Max. 75 mA
Low lens, clear	239 480 55
Raised lens, opaque	239 482 55

! ADDITIONAL INFORMATION:

The LED beacon 239 is suitable for applications on machines or in control panels.

The LED installation beacon (multicolour) can be single-hole mounted with ease thanks to its M22 installation dimensions.

X1	X2	X3	X4	X5	Colour
		24V DC	nc	COM	OFF
	24V DC		nc	COM	GN
	24V DC	24V DC	nc	COM	YE
24V DC			nc	COM	BU
24V DC	24V DC	24V DC	nc	COM	WH

TECHNICAL DIAGRAMS:

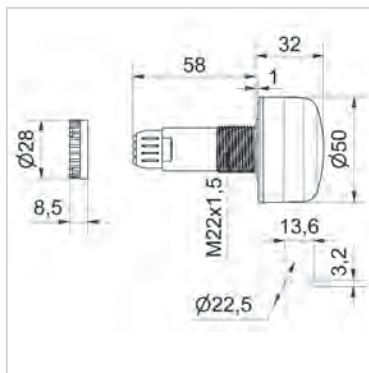

239.482.55

Signalisation index	
LED Permanent Light (multicolour)	3





i TECHNICAL SPECIFICATIONS/ORDER SPECIFICATIONS:

Dimensions (Ø x Height):	50 mm x 22 mm (Protrusion from panel)
Housing:	PC/ABS-Blend, black
Lens:	PC, transparent
Fixing:	Installation mounting for Ø 22.5 mm (M22 x 1.5 mm) with anti-twist device
Connection:	Screw terminal with wire protection max. 1.5 mm ²
Power supply AS-Interface:	Via bus conduction
Operating voltage:	25 V ... 31.6 V according to the AS-Interface specification
Current consumption:	≤ 100 mA
Specification:	V 3.0
IO-Code:	8 _{HEX}
ID-Code:	A _{HEX}
ID2-Code:	E _{HEX}
Colour options:	Red, yellow, green, white, blue
Life duration:	Up to 50,000 hrs
Nut and seal included in assembly.	

LED Installation Beacon (multicolour) for AS-Interface **239 780 55**

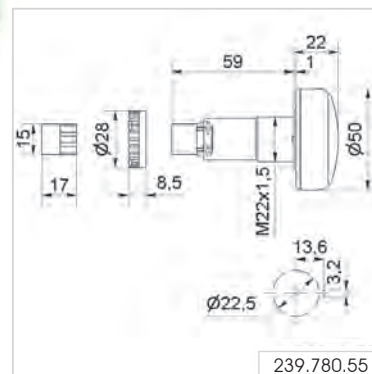

Five colours in one beacon:
red, yellow, green, white and blue

TECHNICAL DIAGRAM:

Signalisation index

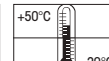
LED Permanent Light (multicolour) 3



Mini Signal Beacons - 2xx and 800/801/802/815/816/817 families

Size comparison Mini 239/Mini



Signalisation index

Optical	
LED Permanent Light 2xx + 8xx	3
LED Blinking Light 8xx	3
LED Rotating Light 8xx	4
Permanent Light 2xx + 8xx	2
Xenon Flashing Light 2xx + 8xx	4

Your benefits

The Mini Signal Beacons are used wherever space is restricted.

The beacons are easy to install and connect, even in tight spaces, thanks to convenient connection terminals and easily accessible mounting holes.

- Reliable signalling at close quarters
- Available as a permanent light or as a bright Xenon flash light to attract attention

The 8xx range:

- Robust and tamper-proof

Typical applications

Signalling of faults

- On small machines and equipment
- In building technology

Installation options

- Base mounting
- M22/PG29 single-hole mounting
- Bracket mounting
- Tube mounting

Features

- High protection rating IP65 for both indoor and outdoor use

The 815 / 816 / 817 family:

- Robust and shock-resistant up to 20 joules





i TECHNICAL SPECIFICATIONS/ORDER SPECIFICATIONS:

Dimensions (Ø x Height): 58 mm x 69 mm (Protrusion from panel)

Housing: PA-GF, high impact

Lens: PC, transparent
Ring: PC

Connection: Spades 6.3 x 0.8 mm
Finger-proof model according to BGV A2, when used with insulated spades

Fixing: Installation mounting for Ø 22.5 mm (M22 x 1.5 mm) with anti-twist device

Life duration: Up to 100,000 hrs

Voltage:	24 V AC/DC	115 V AC	230 V AC
Current consumption:	45 mA	25 mA	25 mA
red	207 100 75	207 100 67	207 100 68
green	207 200 75	207 200 67	207 200 68
yellow	207 300 75	207 300 67	207 300 68

TECHNICAL DIAGRAM:

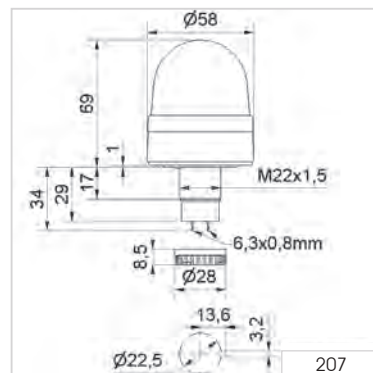

Signalisation index

LED Permanent Light 3



LED Permanent Beacon 201 (base mounting)



LED Permanent Beacon 204 with integrated mounting bracket

i TECHNICAL SPECIFICATIONS/ORDER SPECIFICATIONS:

	Base mounting 201	Bracket mounting 204
Dimensions (Ø x Height):	58 mm x 81 mm	58 mm x 107 mm
Housing:	PA-GF, high impact	
Lens:	PC, transparent; Ring: PC	
Connection:	CAGE CLAMP® technology max. 1.5 mm ²	
Cable entry:	Cable diameter max. 10 mm	Cable diameter 3-6 mm
Fixing:	Base mounting with flat seal	Bracket mounting incl. cable gland M 12 x 1.5 mm
Life duration:	Up to 100,000 hrs	

Base mounting 201

	24 V AC/DC	115 V AC	230 V AC
Current consumption:	45 mA	25 mA	25 mA
red	201 100 75	201 100 67	201 100 68
green	201 200 75	201 200 67	201 200 68
yellow	201 300 75	201 300 67	201 300 68

Bracket mounting 204

	24 V AC/DC	115 V AC	230 V AC
Current consumption:	45 mA	25 mA	25 mA
red	204 100 75	204 100 67	204 100 68
green	204 200 75	204 200 67	204 200 68
yellow	204 300 75	204 300 67	204 300 68

TECHNICAL DIAGRAMS:

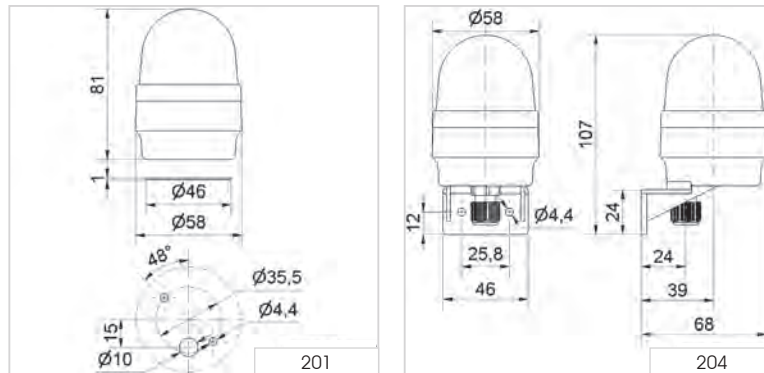

Signalisation index

LED Permanent Light		3
---------------------	--	---

Base mounting Bracket mounting 24 V





Base with integrated tube (accessory)

i TECHNICAL SPECIFICATIONS/ORDER SPECIFICATIONS:

Dimensions (Ø x Height): 58 mm x 103 mm			
Housing: PA-GF, high impact			
Lens: PC, transparent; Ring: PC			
Connection: CAGE CLAMP® technology max. 1.5 mm ²			
Cable entry: Cable diameter max. 11 mm			
Fixing: Tube mounting M25 x 1.5 mm			
Life duration: Up to 100,000 hrs			
Voltage:	24 V AC/DC	115 V AC	230 V AC
Current consumption:	45 mA	25 mA	25 mA
red	209 110 75	209 110 67	209 110 68
green	209 210 75	209 210 67	209 210 68
yellow	209 310 75	209 310 67	209 310 68

ACCESSORIES:

Base with integrated tube, 100 mm long, M25 x 1.5 mm	975 209 01
Cable gland M25 x 1.5 mm	975 209 02

TECHNICAL DIAGRAM:

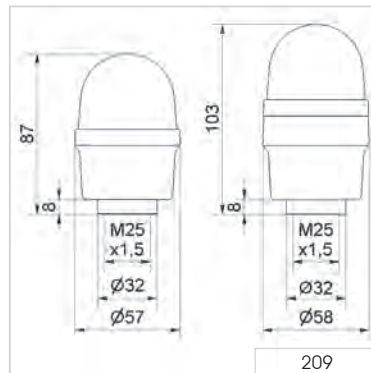

Signalisation index	
LED Permanent Light	3



LED Permanent Beacon 211 (base mounting)



LED Permanent Beacon 214 with integrated mounting bracket



Housing with CAGE CLAMP® connection

i TECHNICAL SPECIFICATIONS/ORDER SPECIFICATIONS:

	Base mounting 211	Bracket mounting 214
Dimensions (Ø x Height):	58 mm x 97 mm	58 mm x 123 mm
Housing:	PA-GF, high impact	
Lens:	PC, transparent; Ring: PC	
Connection:	CAGE CLAMP® technology max. 1.5 mm ²	
Cable entry:	Cable diameter max. 10 mm	Cable diameter 3-6 mm
Fixing:	Base mounting with flat seal	Bracket mounting incl. cable gland M12 x 1.5 mm
Life duration:	Up to 100,000 hrs	

Base mounting 211			
Voltage:	24 V AC/DC	115 V AC	230 V AC
Current consumption:	45 mA	25 mA	25 mA
red	211 100 75	211 100 67	211 100 68
green	211 200 75	211 200 67	211 200 68
yellow	211 300 75	211 300 67	211 300 68

Bracket mounting 214			
Voltage:	24 V AC/DC	115 V AC	230 V AC
Current consumption:	45 mA	25 mA	25 mA
red	214 100 75	214 100 67	214 100 68
green	214 200 75	214 200 67	214 200 68
yellow	214 300 75	214 300 67	214 300 68

TECHNICAL DIAGRAMS:

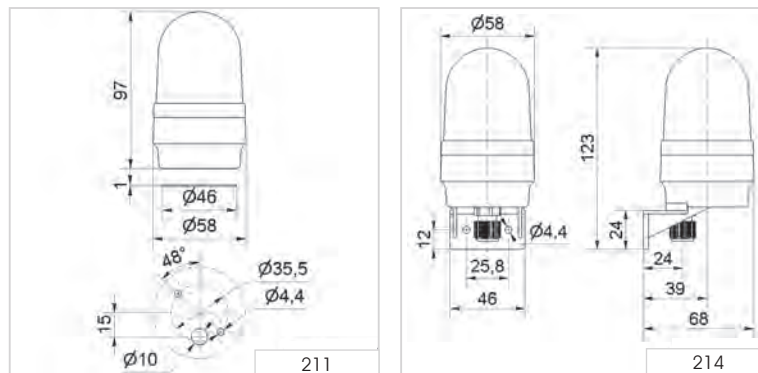

Signalisation index	
LED Permanent Light	3





Base with integrated tube (accessory)

i TECHNICAL SPECIFICATIONS/ORDER SPECIFICATIONS:

Dimensions (Ø x Height): 58 mm x 103 mm			
Housing: PA-GF, high impact			
Lens: PC, transparent; Ring: PC			
Connection: CAGE CLAMP® technology max. 1.5 mm ²			
Cable entry: Cable diameter max. 11 mm			
Fixing: Tube mounting, M25 x 1.5 mm			
Life duration: Up to 100,000 hrs			
Voltage:	24 V AC/DC	115 V AC	230 V AC
Current consumption:	45 mA	25 mA	25 mA
red	219 110 75	219 110 67	219 110 68
green	219 210 75	219 210 67	219 210 68
yellow	219 310 75	219 310 67	219 310 68

ACCESSORIES:

Base with integrated tube, 110 m long, M25 x 1.5 mm	975 209 01
Cable gland M25 x 1.5 mm	975 209 02

TECHNICAL DIAGRAM:

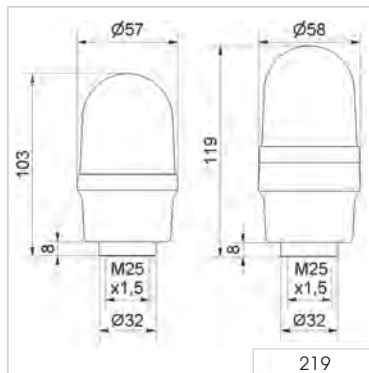

Signalisation index	
LED Permanent Light	3



LED Permanent Beacon 221 (base mounting)



LED Permanent Beacon 224 with integrated mounting bracket

i TECHNICAL SPECIFICATIONS/ORDER SPECIFICATIONS:

	Base mounting 221	Bracket mounting 224
Dimensions (Ø x Height):	75 mm x 79 mm	75 mm x 105 mm
Housing:	PA-GF, high impact	
Lens:	PC, transparent; Ring: PC /ABS-Blend	
Connection:	CAGE CLAMP® technology max. 1.5 mm ²	
Cable entry:	Cable diameter max. 10 mm	Cable diameter 3-6 mm
Fixing:	Base mounting with flat seal	Bracket mounting incl. cable gland M12 x 1.5 mm
Life duration:	Up to 100,000 hrs	

Base mounting 221

	24 V AC/DC	115 V AC	230 V AC
Current consumption:	45 mA	25 mA	25 mA
red	221 100 75	221 100 67	221 100 68
green	221 200 75	221 200 67	221 200 68
yellow	221 300 75	221 300 67	221 300 68

Bracket mounting 224

	24 V AC/DC	115 V AC	230 V AC
Current consumption:	45 mA	25 mA	25 mA
red	224 100 75	224 100 67	224 100 68
green	224 200 75	224 200 67	224 200 68
yellow	224 300 75	224 300 67	224 300 68

TECHNICAL DIAGRAMS:

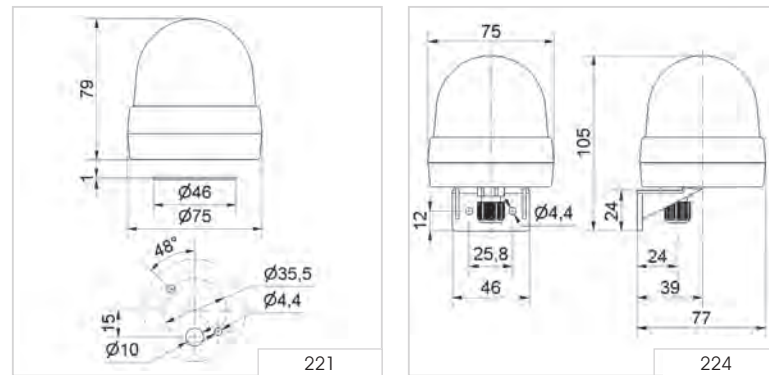

Signalisation index

LED Permanent Light 3

Base mounting Bracket mounting 24 V





Bulb change via removal of lens (LED bulb as accessory)



Accessories

i TECHNICAL SPECIFICATIONS/ORDER SPECIFICATIONS:

Dimensions (Ø x Height):	57 mm x 53 mm (Protrusion from panel)		
Housing:	PA-GF, high impact		
Lens:	PC, transparent		
Fixing:	Installation mounting for Ø 22.5 mm (M22 x 1.5 mm) with anti-twist device		
Connection:	Spades 6.3 x 0.8 mm Finger-proof model according to BGV A2, when used with insulated spades		
Operating voltage:	Max. 48 V		
Bulb socket:	BA15d 5 Watt max.		
Bulb change:	Via removal of lens		
Nut and seal included in assembly. Bulb not included in assembly.			
Voltage:	12-48 V		
red	206 100 00		
green	206 200 00		
yellow	206 300 00		
clear	206 400 00		
blue	206 500 00		
Further colours and voltages on request.			

🏠 ACCESSORIES:

LED bulb BA15d, 5 W, total length 42 mm			
Voltage:	12 V AC/DC	24 V AC/DC	30 V AC/DC
	955 840 34	955 840 35	955 840 32
LED bulb BA15d total length 42 mm			
Voltage:	24 V AC/DC		
Current consumption:	< 45 mA		
red	956 100 75		
green	956 200 75		
yellow	956 300 75		
white	956 400 75		
blue	956 500 75		

📐 TECHNICAL DIAGRAM:

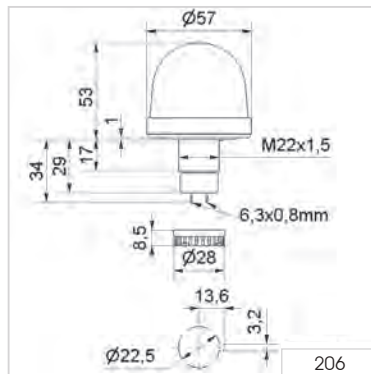

Signalisation index	
Permanent Light	 2

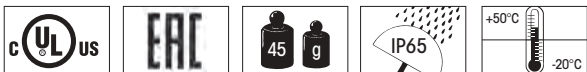



Permanent Beacon 200 (base mounting)



Permanent Beacon 203 with integrated mounting bracket

i TECHNICAL SPECIFICATIONS/ORDER SPECIFICATIONS:

	Base mounting 200	Bracket mounting 203
Dimensions (Ø x Height):	57 mm x 65.5 mm	57 mm x 91 mm
Housing:		PA-GF, high impact
Lens:		PC, transparent
Connection:		CAGE CLAMP® technology max. 1.5 mm ²
Cable entry:	Cable diameter max. 10 mm	Cable diameter 3-6 mm
Fixing:	Base mounting with flat seal	Bracket mounting incl. cable gland M 12 x 1.5 mm
Operating voltage:		12-230 V
Bulb socket:		BA15d, 7 Watt max.
Bulb change:		Via removal of lens
Bulb not included in assembly.		
Voltage:	12-230 V	12-230 V
red	200 100 00	203 100 00
green	200 200 00	203 200 00
yellow	200 300 00	203 300 00
clear	200 400 00	203 400 00
blue	200 500 00	203 500 00

ACCESSORIES:

Bulb BA15d, 5 W total length 42 mm					
Voltage:	12 V AC/DC	24 V AC/DC	30 V AC/DC	115 V AC/DC	230 V AC/DC
	955 840 34	955 840 35	955 840 32	955 840 57	955 840 38
LED bulb BA15d, total length 42 mm					
Voltage:	24 V AC/DC			115 V AC	230 V AC
Current consumption:	< 45 mA			< 15 mA	< 15 mA
red	956 100 75			956 100 67	956 100 68
green	956 200 75			956 200 67	956 200 68
yellow	956 300 75			956 300 67	956 300 68
white	956 400 75			956 400 67	956 400 68
blue	956 500 75			956 500 67	956 500 68

TECHNICAL DIAGRAMS:



Accessoires

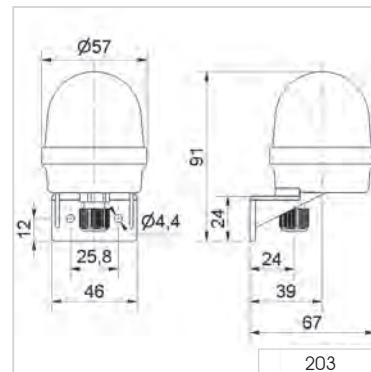
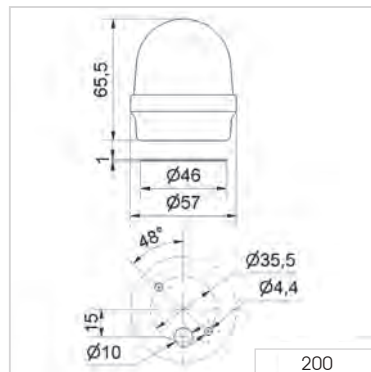

Signalisation index	
Permanent Light	 2





Accessories

i TECHNICAL SPECIFICATIONS/ORDER SPECIFICATIONS:

Dimensions (Ø x Height):	57 mm x 87 mm
Housing:	PA-GF, high impact
Lens:	PC, transparent
Connection:	CAGE CLAMP® technology max. 1.5 mm ²
Cable entry:	Cable diameter max. 11 mm
Fixing:	Tube mounting M25 x 1.5 mm
Operating voltage:	12-230 V
Bulb socket:	BA15d, 7 Watt max.
Bulb change:	Via removal of lens

Bulb not included in assembly.

Voltage:	12-240 V
red	209 100 00
green	209 200 00
yellow	209 300 00
clear	209 400 00
blue	209 500 00

ACCESSORIES:

Base with integrated tube 110 mm long, M25 x 1.5 mm	975 209 01
--	-------------------

Cable gland M25 x 1.5 mm	975 209 02
-----------------------------	-------------------

Bulb BA15d, 5 W, total length 42 mm					
Voltage:	12 V AC/DC	24 V AC/DC	30 V AC/DC	115 V AC/DC	230 V AC/DC
	955 840 34	955 840 35	955 840 32	955 840 57	955 840 38

LED bulb BA15d total length 42 mm				
Voltage:	24 V AC/DC		115 V AC	230 V AC
Current consumption:	< 45 mA		< 15 mA	< 15 mA
red	956 100 75		956 100 67	956 100 68
green	956 200 75		956 200 67	956 200 68
yellow	956 300 75		956 300 67	956 300 68
white	956 400 75		956 400 67	956 400 68
blue	956 500 75		956 500 67	956 500 68

TECHNICAL DIAGRAM:

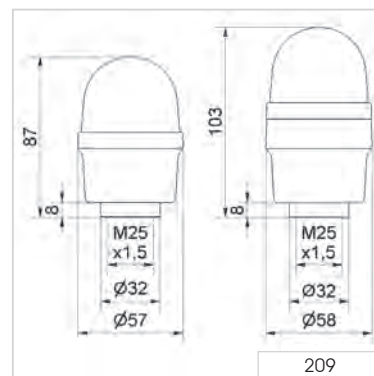

Signalisation index

Permanent Light 2





Bulb change via removal of lens (LED bulb as accessory)



Accessories

i TECHNICAL SPECIFICATIONS/ORDER SPECIFICATIONS:

Dimensions (Ø x Height): 57 mm x 69 mm (Protrusion from panel)

Housing: PA-GF, high impact

Lens: PC, transparent
Ring: PC

Connection: Spades 6.3 mm x 0.8 mm
Finger-proof model according to BGV A2, when used with insulated spades

Fixing: Installation mounting for Ø22.5 mm (M22 x 1.5 mm) with anti-twist device

Operating voltage: Max. 48 V

Bulb socket: BA15d, 7 Watt max.

Bulb change: Via removal of lens

Nut and seal included in assembly. Bulb not included in assembly.

Voltage:	12-48 V
red	216 100 00
green	216 200 00
yellow	216 300 00
clear	216 400 00
blue	216 500 00

ACCESSORIES:

Bulb BA15d, total length 54 mm			total length 42 mm
Voltage:	12 V AC/DC (7 W)	24 V AC/DC (7 W)	30 V AC/DC (5 W)
	955 015 34	955 015 35	955 840 32
LED bulb BA15d, total length 42 mm			
Voltage:	24 V AC/DC		
Current consumption:	< 45 mA		
red	956 100 75		
green	956 200 75		
yellow	956 300 75		
clear	956 400 75		
blue	956 500 75		

TECHNICAL DIAGRAM:

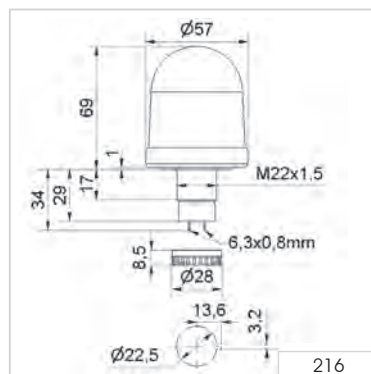

Signalisation index	
Permanent Light	 2





Permanent Beacon 210 (base mounting)



Permanent Beacon 213 with integrated mounting bracket



Accessories

i TECHNICAL SPECIFICATIONS/ORDER SPECIFICATIONS:

	Base mounting 210	Bracket mounting 213
Dimensions (Ø x Height):	57 mm x 81 mm	57 mm x 107 mm
Housing:		PA-GF, high impact
Lens:		PC, transparent
Connection:		CAGE CLAMP® technology max. 1.5 mm ²
Cable entry:	Cable diameter max. 10 mm	Cable diameter 3-6 mm
Fixing:	Base mounting with flat seal	Bracket mounting incl. cable gland M12 x 1.5 mm
Operating voltage:		12-230 V
Bulb socket:		BA15d, 10 Watt max.
Bulb change:		Via removal of lens
Bulb not included in assembly.		
Voltage:	12-230 V	12-230 V
red	210 100 00	213 100 00
green	210 200 00	213 200 00
yellow	210 300 00	213 300 00
clear	210 400 00	213 400 00
blue	210 500 00	213 500 00

ACCESSORIES:

Bulb BA15d, 7 W, total length 54 mm

Voltage:	12 V AC/DC	24 V AC/DC	48 V AC/DC	115 V AC/DC	230 V AC/DC
	955 015 34	955 015 35	955 015 36	955 015 37	955 015 38

LED bulb BA15d, total length 42 mm

Voltage:	24 V AC/DC	115 V AC	230 V AC
Current consumption:	< 45 mA	< 15 mA	< 15 mA
red	956 100 75	956 100 67	956 100 68
green	956 200 75	956 200 67	956 200 68
yellow	956 300 75	956 300 67	956 300 68
clear	956 400 75	956 400 67	956 400 68
blue	956 500 75	956 500 67	956 500 68

TECHNICAL DIAGRAMS:

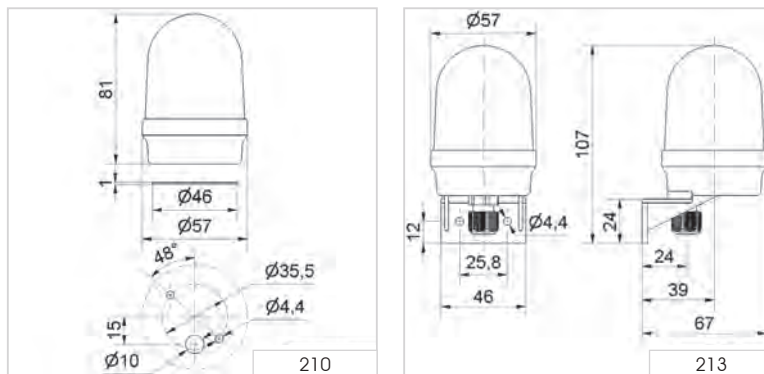

Signalisation index

Permanent Light 2

Base mounting

Bracket mounting





Accessories

Signalisation index

Permanent Light 2

i TECHNICAL SPECIFICATIONS/ORDER SPECIFICATIONS:

Dimensions (Ø x Height): 57 mm x 103 mm
Housing: PA-GF, high impact
Lens: PC, transparent
 Ring: PC
Connection: CAGE CLAMP® technology max. 1.5 mm²
Cable entry: Cable diameter max. 11 mm
Fixing: Tube mounting, M25 x 1.5 mm
Operating voltage: 12-230 V
Bulb socket: BA15d, 10 Watt max.
Bulb change: Via removal of lens
 Bulb not included in assembly.

Voltage: 12-230 V
 red **219 100 00**
 green **219 200 00**
 yellow **219 300 00**
 clear **219 400 00**
 blue **219 500 00**

ACCESSORIES:

Base with integrated tube, M25 x 1.5 mm **975 209 01**

Cable gland M25 x 1.5 mm **975 209 02**

Bulb BA15d, 7 W, total length 54 mm

Voltage:	12 V AC/DC	24 V AC/DC	48 V AC/DC	115 V AC/DC	230 V AC/DC
	955 015 34	955 015 35	955 015 36	955 015 37	955 015 38

LED bulb BA15d, total length 42 mm

Voltage:	24 V AC/DC	115 V AC	230 V AC
Current consumption:	< 45 mA	< 15 mA	< 15 mA
red	956 100 75	956 100 67	956 100 68
green	956 200 75	956 200 67	956 200 68
yellow	956 300 75	956 300 67	956 300 68
clear	956 400 75	956 400 67	956 400 68
blue	956 500 75	956 500 67	956 500 68

TECHNICAL DIAGRAM:

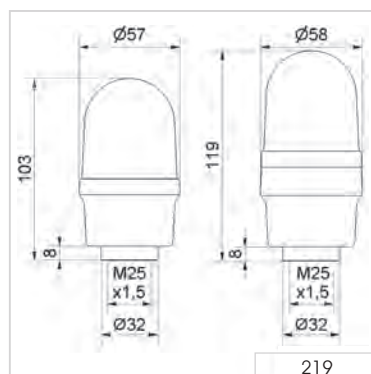



Permanent Beacon 220 (base mounting)



Permanent Beacon 223 with integrated mounting bracket



Housing with CAGE CLAMP® connection

i TECHNICAL SPECIFICATIONS/ORDER SPECIFICATIONS:

	Base mounting 220	Bracket mounting 223
Dimensions (Ø x Height):	75 mm x 79 mm	75 mm x 105 mm
Housing:	PA-GF, high impact	
Lens:	PC, transparent; Ring: PC/ABS-Blend	
Connection:	CAGE CLAMP® technology max. 1.5 mm ²	
Cable entry:	Cable diameter max. 10 mm	Cable diameter 3-6 mm
Fixing:	Base mounting with flat seal	Bracket mounting incl. cable gland M12 x 1.5 mm
Operating voltage:	12-230 V	
Bulb socket:	BA15d, 7 Watt max.	
Bulb change:	Via removal of lens	
Bulb not included in assembly.		
Voltage:	12-230 V	12-230 V
red	220 100 00	223 100 00
green	220 200 00	223 200 00
yellow	220 300 00	223 300 00
clear	220 400 00	223 400 00
blue	220 500 00	223 500 00

ACCESSORIES:

Bulb BA15d, 7 W total length 54 mm

Voltage:	12 V AC/DC	24 V AC/DC	48 V AC/DC	115 V AC/DC	230 V AC/DC
	955 015 34	955 015 35	955 015 36	955 015 37	955 015 38

LED bulb BA15d total length 42 mm

Voltage:	24 V AC/DC	115 V AC	230 V AC
Current consumption:	< 45 mA	< 15 mA	< 15 mA
red	956 100 75	956 100 67	956 100 68
green	956 200 75	956 200 67	956 200 68
yellow	956 300 75	956 300 67	956 300 68
clear	956 400 75	956 400 67	956 400 68
blue	956 500 75	956 500 67	956 500 68

TECHNICAL DIAGRAMS:

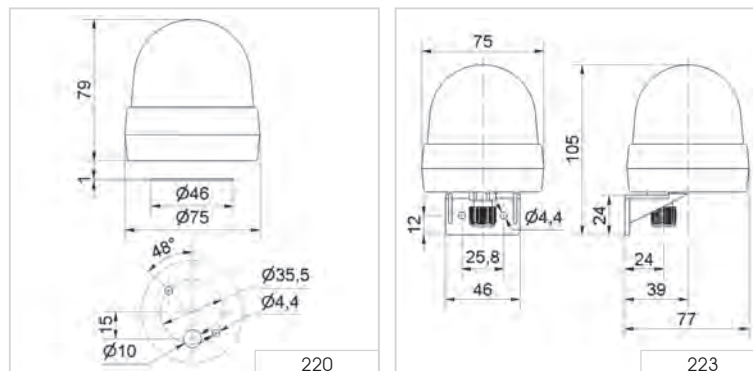

Signalisation index

Permanent Light 2

Base mounting 97 g Bracket mounting 103 g IP65 +50°C -20°C

Signal Beacons & Traffic Lights





i TECHNICAL SPECIFICATIONS/ORDER SPECIFICATIONS:

Dimensions (Ø x Height): 58 mm x 69 mm (Protrusion from panel)			
Housing: PA-GF, high impact			
Lens: PC, transparent; Ring: PC			
Connection: Spades 6.3 x 0.8 mm Finger-proof model according to BGV A2, when used with insulated spades			
Fixing: Installation mounting for Ø 22.5 mm (M22 x 1.5 mm) with anti-twist device			
Flash frequency: C. 0.75 Hz			
Flash energy: 1 Ws			
Life duration: 4 x 10 ⁶ flashes			
Nut and seal included in assembly.			
Voltage:	24 V DC	115 V AC	230 V AC
Current consumption:	100 mA	25 mA	30 mA
red	208 100 55	208 100 67	208 100 68
yellow	208 300 55	208 300 67	208 300 68

TECHNICAL DIAGRAM:

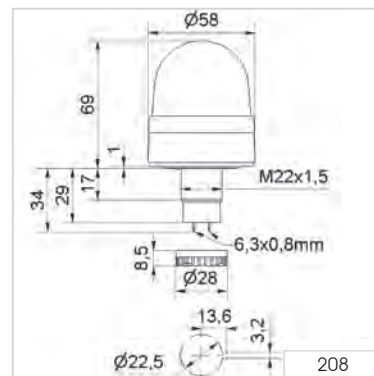

Signalisation index

Xenon Flashing Light 4

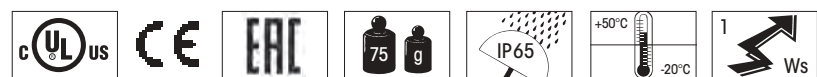



Flashing Beacon 202 (base mounting)



Flashing Beacon 205 with integrated mounting bracket



Housing with CAGE CLAMP® connection

i TECHNICAL SPECIFICATIONS/ORDER SPECIFICATIONS:

	Base mounting 202	Bracket mounting 205
Dimensions (Ø x Height):	58 mm x 81 mm	58 mm x 107 mm
Housing:	PA-GF, high impact	
Lens:	PC, transparent; Ring: PC	
Connection:	CAGE CLAMP® technology max. 1.5 mm ²	
Cable entry:	Cable diameter max. 10 mm	Cable diameter 3-6 mm
Fixing:	Base mounting with flat seal	Bracket mounting ncl. cable gland M12 x 1.5 mm
Flash frequency:	C. 0.75 Hz	
Flash energy:	1 Ws	
Life duration:	4 x 10 ⁶ flashes	

Base mounting 202

Voltage:	24 V AC/DC	115 V AC	230 V AC
Current consumption:	100 mA	20 mA	30 mA
red	202 100 55	202 100 67	202 100 68
yellow	202 300 55	202 300 67	202 300 68

Bracket mounting 205

Voltage:	24 V AC/DC	115 V AC	230 V AC
Current consumption:	100 mA	20 mA	30 mA
red	205 100 55	205 100 67	205 100 68
yellow	205 300 55	205 300 67	205 300 68

TECHNICAL DIAGRAM:

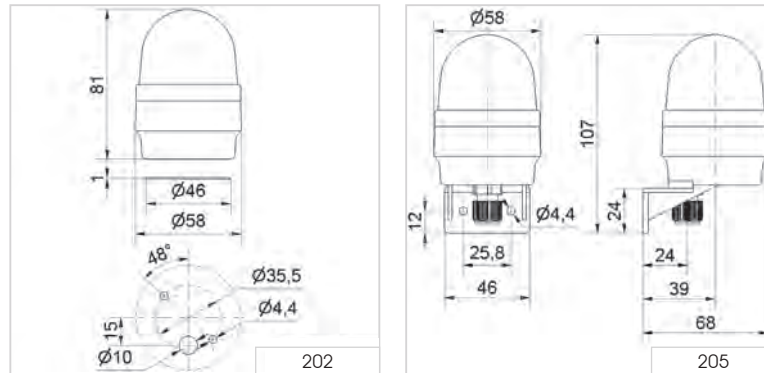

Signalisation index

Xenon Flashing Light	4
----------------------	---

Base mounting Bracket mounting





Base with integrated tube (accessory)

i TECHNICAL SPECIFICATIONS/ORDER SPECIFICATIONS:

Dimensions (Ø x Height): 58 mm x 103 mm			
Housing:	PA-GF, high impact		
Lens:	PC, transparent		
	Ring: PC		
Connection:	CAGE CLAMP® technology max 1.5 mm ²		
Cable entry:	Cable diameter max. 11 mm		
Fixing:	Tube mounting M25 x 1.5 mm		
Flash frequency:	C. 0.75 Hz		
Flash energy:	1 Ws		
Life duration:	4 x 10 ⁶ flashes		
Voltage:	24 V DC	115 V AC	230 V AC
Current consumption:	100 mA	20 mA	30 mA
red	209 120 55	209 120 67	209 120 68
yellow	209 320 55	209 320 67	209 320 68

ACCESSORIES:

Base with integrated tube, 110 mm long, M25 x 1.5 mm	975 209 01
Cable gland M25 x 1.5 mm	975 209 02

TECHNICAL DIAGRAM:

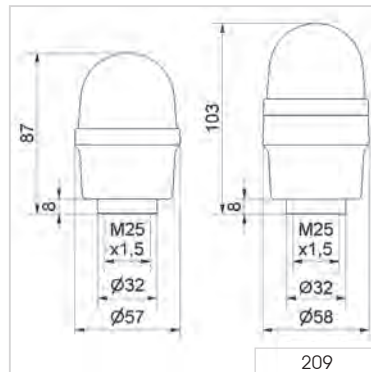

Signalisation index

Xenon Flashing Light 4

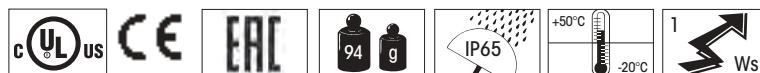

212/215 Xenon Flashing Beacon - Base/Bracket mounting



Flashing Beacon 212
(Base mounting)



Flashing Beacon 215 with
integrated mounting bracket

TECHNICAL SPECIFICATIONS/ORDER SPECIFICATIONS:

	Base mounting 212	Bracket mounting 215
Dimensions (Ø x Height):	58 mm x 97 mm	58 mm x 123 mm
Housing:	PA-GF, high impact	
Lens:	PC, transparent; Ring: PC	
Connection:	CAGE CLAMP® technology max. 1.5 mm ²	
Cable entry:	Cable diameter max. 10 mm	Cable diameter 3-6 mm
Fixing:	Base mounting with flat seal	Bracket mounting incl. cable gland M12 x 1.5 mm
Flash frequency:	C. 0.75 Hz	
Flash energy:	1 Ws	
Life duration:	4 x 10 ⁶ flashes	

Base mounting 212			
Voltage:	24 V AC/DC	115 V AC	230 V AC
Current consumption:	100 mA	20 mA	30 mA
red	212 100 55	212 100 67	212 100 68
yellow	212 300 55	212 300 67	212 300 68

Bracket mounting 215			
Voltage:	24 V AC/DC	115 V AC	230 V AC
Current consumption:	100 mA	20 mA	30 mA
red	215 100 55	215 100 67	215 100 68
yellow	215 300 55	215 300 67	215 300 68

TECHNICAL DIAGRAMS:

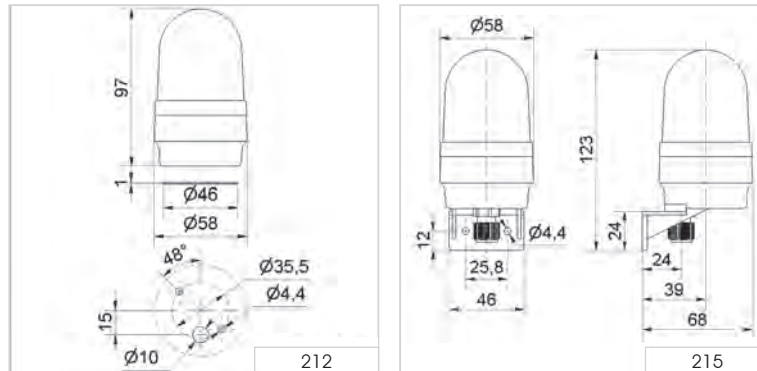

Signalisation index	
Xenon Flashing Light	4

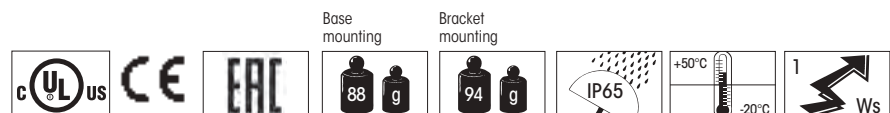



Base with tube (accessory)



i TECHNICAL SPECIFICATIONS/ORDER SPECIFICATIONS:

Dimensions (Ø x Height): 58 mm x 119 mm			
Housing:	PA-GF, high impact		
Lens:	PC, transparent		
	Ring: PC		
Connection:	CAGE CLAMP® technology max. 1.5 mm ²		
Cable entry:	Cable diameter max. 11 mm		
Fixing:	Tube mounting M25 x 1.5 mm		
Flash frequency:	C. 0.75 Hz		
Flash energy:	1 Ws		
Life duration:	4 x 10 ⁶ flashes		
Voltage:	24 V DC	115 V AC	230 V AC
Current consumption:	100 mA	20 mA	30 mA
red	219 120 55	219 120 67	219 120 68
yellow	219 320 55	219 320 67	219 320 68

ACCESSORIES:

Base with integrated tube, 110 mm long, M25 x 1.5 mm	975 209 01
Cable gland M25 x 1.5 mm	975 209 02

TECHNICAL DIAGRAM:

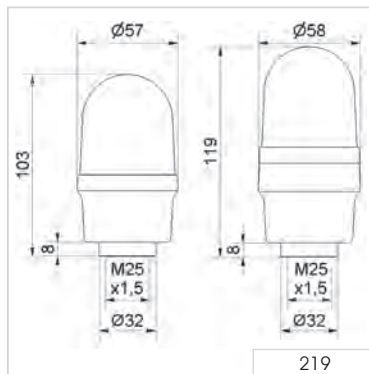

Signalisation index	
Xenon Flashing Light	4





Flashing Beacon 222 (base mounting)



Flashing Beacon 225 with integrated mounting bracket

i TECHNICAL SPECIFICATIONS/ORDER SPECIFICATIONS:

	Base mounting 222	Bracket mounting 225
Dimensions (Ø x Height):	75 mm x 79 mm	75 mm x 105 mm
Housing:	PA-GF, high impact	
Lens:	PC, transparent; Ring: PC/ABS-Blend	
Connection:	CAGE CLAMP® technology max. 1.5 mm ²	
Cable entry:	Cable diameter max. 10 mm	Cable diameter 3-6 mm
Fixing:	Base mounting with flat seal	Bracket mounting incl. cable gland M12 x 1.5 mm
Flash frequency:	C. 0.75 Hz	
Flash energy:	1 Ws	
Life duration:	4 x 10 ⁶ flashes	

Base mounting 222			
Voltage:	24 V DC	115 V AC	230 V AC
Current consumption:	100 mA	20 mA	30 mA
red	222 100 55	222 100 67	222 100 68
yellow	222 300 55	222 300 67	222 300 68

Bracket mounting 225			
Voltage:	24 V DC	115 V AC	230 V AC
Current consumption:	100 mA	20 mA	30 mA
red	225 100 55	225 100 67	225 100 68
yellow	225 300 55	225 300 67	225 300 68
blue	225 500 55	225 500 67	225 500 68

TECHNICAL DIAGRAMS:

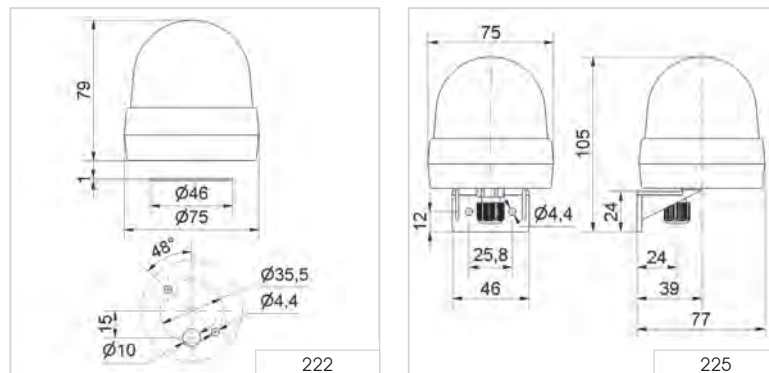

Signalisation index

Xenon Flashing Light 4

Base mounting 124 g Bracket mounting 130 g IP65 +50°C / -20°C 1 Ws

Signal Beacons & Traffic Lights





i TECHNICAL SPECIFICATIONS/ORDER SPECIFICATIONS:

Housing:	PA-GF, high-impact
Lens:	PC, transparent
Socket:	BA15d
Life duration:	Up to 50,000 hrs
For use with:	200, 203, 206, 209, 210, 213, 216, 219, 220, 223, 641, 805, 840, 846, 850, 851, 852

Slight deviations in the form of the bulbs are possible.

Voltage:	24 V AC/DC	115 V AC	230 V AC
Current consumption:	≤ 45 mA	≤ 15 mA	≤ 15 mA
red	956 100 75	956 100 67	956 100 68
green	956 200 75	956 200 67	956 200 68
yellow	956 300 75	956 300 67	956 300 68
white	956 400 75	956 400 67	956 400 68
blue	956 500 75	956 500 67	956 500 68

TECHNICAL DIAGRAM:

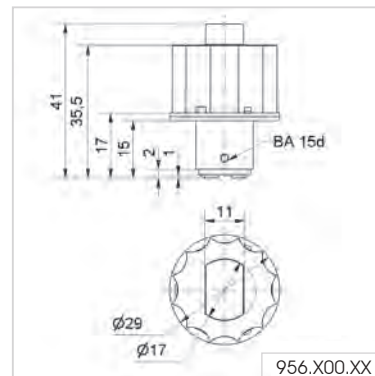



Tube adaptor as accessory



Accessories

TECHNICAL SPECIFICATIONS/ORDER SPECIFICATIONS:

Dimensions (Ø x Height): 57 mm x 54 mm (Protrusion from panel)

Housing: PC/ABS-Blend
Socket: PA-GF, high impact

Lens: PC, transparent

Fixing: Installation mounting for Ø 37 mm (PG29)

Connection: Screw terminal 0.5 - 1.5 mm²
flex radial or axial laid

Life duration: Up to 100,000 hrs

Voltage:	24 V AC/DC	115 V AC	230 V AC
Current consumption:	45 mA	25 mA	25 mA
red	801 100 75	801 100 67	801 100 68
green	801 200 75	801 200 67	801 200 68
yellow	801 300 75	801 300 67	801 300 68

Further colours and voltages on request.

ACCESSORIES:

Tube adaptor	975 812 01
Base with integrated tube, Ø 25 mm, 110 mm long, plastic	975 840 10
Base for tube mounting	975 840 90
Base for base mounting	975 812 02
Tube Ø 25 mm, all anodized aluminium	
100 mm long	975 845 10
250 mm long	975 840 25
400 mm long	975 840 40
Anti-twist device	975 815 22
Surface housing IP 65	
for 1 Installation Beacon	975 815 03
for 2 Installation Beacons	975 815 07
for 3 Installation Beacons	975 815 08
for 4 Installation Beacons	975 109 05

TECHNICAL DIAGRAM:

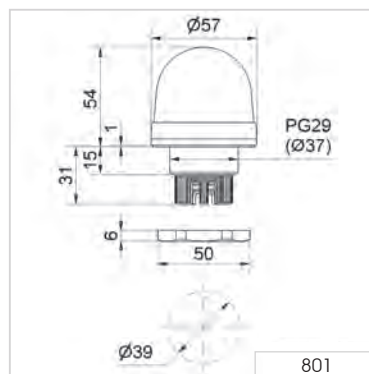

Signalisation index

LED Permanent Light 3

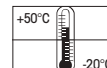
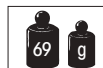

24 V

PLC



816 LED Installation Permanent Beacon - PG29 (Ø 37 mm)



Tube adaptor as accessory



Surface housing as accessory

i TECHNICAL SPECIFICATIONS/ORDER SPECIFICATIONS:

Dimensions (Ø x Height): 75 mm x 66 mm (Protrusion from panel)			
Housing: PC/ABS-Blend			
Socket: PA-GF, high impact			
Lens: PC, transparent			
Shock resistance 20 Joules according to EN 60079-0			
Fixing: Installation mounting for Ø 37 mm (PG29)			
Connection: Screw terminal 0.5 - 1.5 mm ²			
flex radial or axial laid			
Life duration: Up to 100,000 hrs			
Voltage:	24 V AC/DC	115 V AC	230 V AC
Current consumption:	45 mA	25 mA	25 mA
red	816 100 55	816 100 67	816 100 68
green	816 200 55	816 200 67	816 200 68
yellow	816 300 55	816 300 67	816 300 68
clear	816 400 55	816 400 67	816 400 68

🏠 ACCESSORIES:

Tube adaptor	975 812 01
Base with integrated tube, Ø 25 mm, 110 mm long, plastic	975 840 10
Base for tube mounting	975 840 90
Base for base mounting	975 812 02
Tube Ø 25 mm, all anodized aluminium	
100 mm long	975 845 10
250 mm long	975 840 25
400 mm long	975 840 40
Anti-twist device	975 815 22
Surface housing IP 65	
for 1 Installation Beacon	975 815 03
for 2 Installation Beacons	975 815 07
for 3 Installation Beacons	975 815 08
for 4 Installation Beacons	975 109 05
Accessories see page 140	

📐 TECHNICAL DIAGRAM:

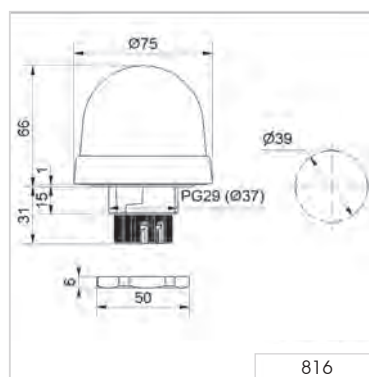

Signalisation index	
LED Permanent Light	3





Tube adaptor as accessory



Surface housing (accessory)

TECHNICAL SPECIFICATIONS/ORDER SPECIFICATIONS:

Dimensions (Ø x Height):	75 mm x 66 mm (Protrusion from panel)
Housing:	PC/ABS-Blend Socket: PA-GF, high impact
Lens:	PC, transparent Shock resistance 20 Joules according to EN 60079-0
Fixing:	Installation mounting for Ø 37 mm (PG29)
Connection:	Screw terminal 0.5 - 1.5 mm ² flex radial or axial laid
Blink frequency:	C. 1 Hz
Life duration:	Up to 50,000 hrs
Voltage:	24 V AC/DC
Current consumption:	25 mA
red	816 110 55
yellow	816 310 55

Further colours and voltages on request.

ACCESSORIES:

Tube adaptor	975 812 01
Base with integrated tube, Ø 25 mm, 110 mm long, plastic	975 840 10
Base for tube mounting	975 840 90
Base for base mounting	975 812 02
Tube Ø 25 mm, all anodized aluminium	
100 mm long	975 845 10
250 mm long	975 840 25
400 mm long	975 840 40
Anti-twist device	975 815 22
Surface housing IP 65	
for 1 Installation Beacon	975 815 03
for 2 Installation Beacons	975 815 07
for 3 Installation Beacons	975 815 08
for 4 Installation Beacons	975 109 05
Accessories see page 140	

TECHNICAL DIAGRAM:

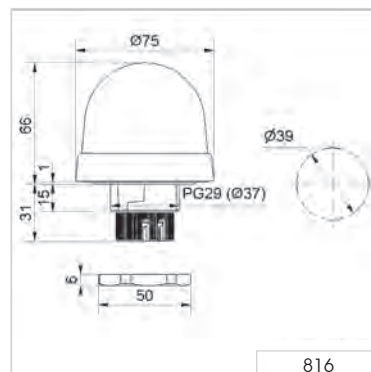

Signalisation index

LED Blinking Light

3

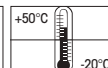

816 LED Permanent Beacon Multicolour - PG29 (Ø 37 mm)



816 Multicolour with clear lens



816 Multicolour with opaque lens



7 colours in one beacon:
red, yellow, green, white, blue,
violet and turquoise

Signalisation index

LED Permanent Light (multicolour) 3

i TECHNICAL SPECIFICATIONS/ORDER SPECIFICATIONS:

Dimensions (Ø x Height):	75 mm x 66 mm (Protrusion from panel)
Housing:	ABS/PC-Blend, black
Lens:	PC, transparent
Fixing:	Shock resistance 20 Joules according to EN 60079-0
Connection:	Installation mounting for Ø 37 mm (PG29)
Colour options:	M12 plug (4 pole)
Life duration:	Red, yellow, green, white, blue, violet, turquoise (multicolour) Up to 50,000 hrs
Voltage:	24 V DC
Current consumption:	max. 120 mA
clear lens	816 480 55
opaque lens	816 780 55

A ACCESSORIES:

Cable 5m with M12 plug	960 693 05
Base for base mounting	975 812 02
Tube adaptor	975 812 01
Base with integrated tube, Ø 25 mm, 110 mm long, plastic	975 840 10
Tube Ø 25 mm, all anodized aluminium	
100 mm long	975 845 10
250 mm long	975 840 25
400 mm long	975 840 40
Base for tube mounting, metal	975 840 91
Anti-twist device	975 815 22

! ADDITIONAL INFORMATION:

Easy triggering

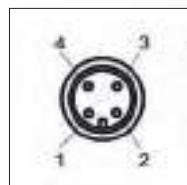

PIN				Colour
1	2	3	4	
24 V	-	GND	-	rd
-	24 V	GND	-	gn
24 V	24 V	GND	-	ye
-	-	GND	24 V	bu
24 V	24 V	GND	24 V	wh
24 V	-	GND	24 V	vt
-	24 V	GND	24 V	tg

1 TECHNICAL DIAGRAM:

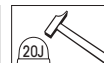
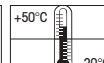
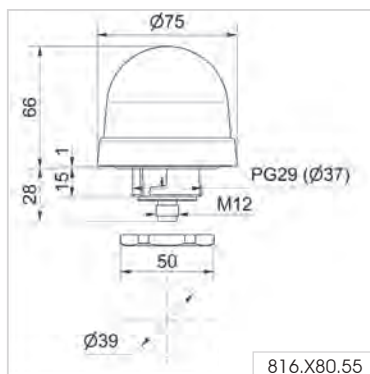

816 LED Beacon (Multicolour) with USB Interface - PG29 (Ø 37 mm)



i TECHNICAL SPECIFICATIONS/ORDER SPECIFICATIONS:

Dimensions (Ø x Height):	75 mm x 66 mm (Protrusion from panel)
Housing:	ABS/PC-Blend, black
Lens:	PC, transparent
	Shock resistance 20 Joules according to EN 60079-0
Fixing:	Installation mounting for Ø 37 mm (PG29)
	Base and wall mounting possible (accessories)
Connection:	Mini USB 2.0 downward cable outlet
Power supply:	Via USB
Colour options:	More than 200,000 colours (RGB LED)
Suitable for:	Windows®, System requirements – see Handbook
Assembly:	LED beacon, demo software, driver and USB connection cable included, 1.8 m long
Life duration:	Up to 50,000 hrs
Voltage:	5 V (USB-Connection)
Current consumption:	≤ 500 mA
clear lens	816 480 53
opaque lens	816 780 53

🏠 ACCESSORIES:

You will find the appropriate accessories for base or tube mounting on page 140 or under www.werma.com

⚠️ ADDITIONAL INFORMATION:

The installation LED Beacon with USB interface is compatible with USB 2.0 and 1.1.

A wide range of colours and light effects can be quickly and simply programmed by the customer and altered at any time.

📐 TECHNICAL DIAGRAM:

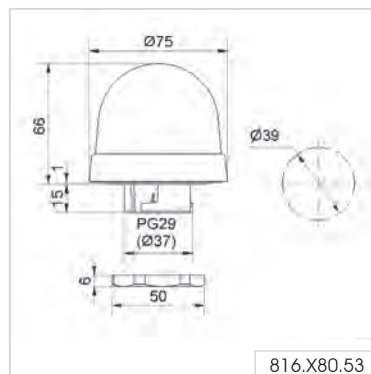

Signalisation index

LED Permanent Light
(multicolour)

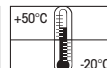



Bulb change via rear access with bayonet holder



Accessories

Signalisation index

Permanent Light 2

i TECHNICAL SPECIFICATIONS/ORDER SPECIFICATIONS:

Dimensions (Ø x Height): 57 mm x 54 mm (Protrusion from panel)

Housing: PC/ABS-Blend
Socket: PA-GF, high impact

Lens: PC, transparent

Connection: Screw terminal 0.5 - 1.5 mm²
Flex radial or axial laid

Fixing: Installation mounting for Ø 37 mm (PG29)

Operating voltage: 12-230 V

Bulb socket: BA15d, 5 Watt max.

Bulb change: Via rear access with bayonet mechanism
Bulb not included in assembly.

Voltage:	12-230 V
red	800 100 00
green	800 200 00
yellow	800 300 00
white	800 400 00
blue	800 500 00

ACCESSORIES:

Bulb BA15d, 5 W total length 42 mm

Voltage:	12 V AC/DC	24 V AC/DC	30 V AC/DC	115 V AC/DC	230 V AC/DC
	955 840 34	955 840 35	955 840 32	955 840 57	955 840 38

Tube adaptor	975 812 01
Base with integrated tube, Ø 25 mm, 110 mm long, plastic	975 840 10
Base for tube mounting	975 840 90
Base for base mounting	975 812 02
Tube Ø 25 mm, all anodized aluminium	
100 mm long	975 845 10
250 mm long	975 840 25
400 mm long	975 840 40
Anti-twist device	975 815 22
Surface housing IP 65	
for 1 Installation Beacon	975 815 03
for 2 Installation Beacons	975 815 07
for 3 Installation Beacons	975 815 08
for 4 Installation Beacons	975 109 05

TECHNICAL DIAGRAM:

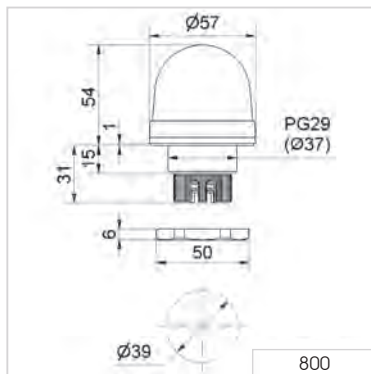



Vandal-proof construction



Accessories

Signalisation index

Permanent Light

i TECHNICAL SPECIFICATIONS/ORDER SPECIFICATIONS:

Dimensions (Ø x Height): 75 mm x 66 mm (Protrusion from panel)

Housing: PC/ABS-Blend, Socket: PA-GF, high impact

Lens: PC, transparent

Shock resistance 20 Joules according to EN 60079-0

Connection: Screw terminal 0.5 -1.5 mm²

flex radial or axial laid

Fixing: Installation mounting for Ø 37 mm (PG29)

Operating voltage: 12-230 V

Bulb socket: BA15d, 5 Watt max.

Bulb change: Via rear access with bayonet mechanism

Bulb not included in assembly.

Voltage: 12-230 V

red 815 100 00

green 815 200 00

yellow 815 300 00

white 815 400 00

blue 815 500 00

ACCESSORIES:

Bulb BA15d, 5 W total length 42 mm

Voltage:	12 V AC/DC	24 V AC/DC	30 V AC/DC	115 V AC/DC	230 V AC/DC
	955 840 34	955 840 35	955 840 32	955 840 57	955 840 38

Tube adaptor	975 812 01
--------------	------------

Base with integrated tube, Ø 25 mm, 110 mm long, plastic	975 840 10
--	------------

Base for tube mounting	975 840 90
------------------------	------------

Base for base mounting	975 812 02
------------------------	------------

Tube Ø 25 mm, all anodized aluminium	
--------------------------------------	--

100 mm long	975 845 10
-------------	------------

250 mm long	975 840 25
-------------	------------

400 mm long	975 840 40
-------------	------------

Anti-twist device	975 815 22
-------------------	------------

Surface housing IP 65	
-----------------------	--

for 1 Installation Beacon	975 815 03
---------------------------	------------

for 2 Installation Beacons	975 815 07
----------------------------	------------

for 3 Installation Beacons	975 815 08
----------------------------	------------

for 4 Installation Beacons	975 109 05
----------------------------	------------

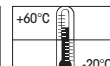
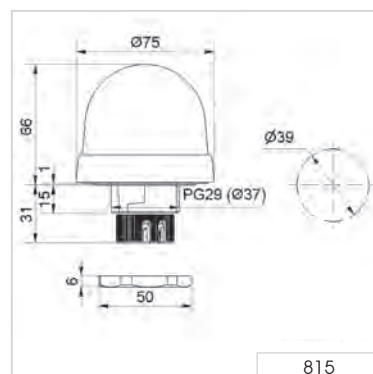
TECHNICAL DIAGRAM:



Tube adaptor as accessory



Accessories

i TECHNICAL SPECIFICATIONS/ORDER SPECIFICATIONS:

Dimensions (Ø x Height): 57 mm x 54 mm (Protrusion from panel)

Housing: PC/ABS-Blend
Socket: PA-GF, high impact

Lens: PC, transparent

Fixing: Installation mounting for Ø 37 mm (PG29)

Connection: Screw terminal 0.5 - 1.5 mm²
flex radial or axial laid

Flash frequency: 0.75 Hz

Flash energy: 1 Ws

Life duration: 4 x 10⁶ flashes

Voltage:	24 V DC	115 V AC	230 V AC
Current consumption:	45 mA	25 mA	25 mA
red	802 100 55	802 100 67	802 100 68
yellow	802 300 55	802 300 67	802 300 68

Further colours and voltages on request.

🏠 ACCESSORIES:

Tube adaptor	975 812 01
Base with integrated tube, Ø 25 mm, 110 mm long, plastic	975 840 10
Base for tube mounting	975 840 90
Base for base mounting	975 812 02
Tube Ø 25 mm, all anodized aluminium	
100 mm long	975 845 10
250 mm long	975 840 25
400 mm long	975 840 40
Anti-twist device	975 815 22
Surface housing IP 65	
for 1 Installation Beacon	975 815 03
for 2 Installation Beacons	975 815 07
for 3 Installation Beacons	975 815 08
for 4 Installation Beacons	975 109 05

📐 TECHNICAL DIAGRAM:

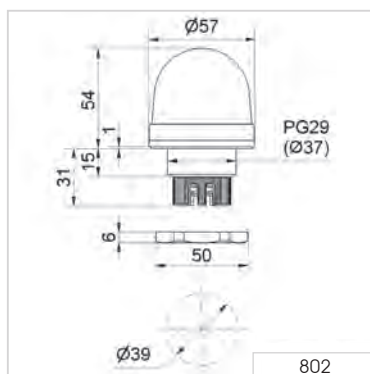

Signalisation index

Xenon Flashing Light

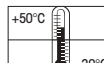
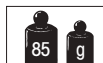

817 Installation Flashing Beacon (Xenon) - PG29 (Ø 37 mm)



Tube adaptor as accessory



Accessories

TECHNICAL SPECIFICATIONS/ORDER SPECIFICATIONS:

Dimensions (Ø x Height): 75 mm x 66 mm (Protrusion from panel)				
Housing:	PC/ABS-Blend			
	Socket: PA-GF, high impact			
Lens:	PC, transparent			
	Shock resistance 20 Joules according to EN 60079-0			
Fixing:	Installation mounting for Ø 37 mm (PG29)			
Connection:	Screw terminal 0.5 - 1.5 mm ²			
	flex radial or axial laid			
Flash frequency:	C. 1 Hz			
Flash energy:	2 Ws			
Life duration:	4 x 10 ⁶ flashes			
Voltage:	12 V DC	24 V DC	115 V AC	230 V AC
Current consumption:	< 195 mA		125 mA	20 mA
	red	817 100 54	817 100 55	817 100 67
yellow	817 300 54	817 300 55	817 300 67	817 300 68

Further colours and voltages on request.

ACCESSORIES:

Tube adaptor	975 812 01
Base with integrated tube, Ø 25 mm, 110 mm long, plastic	975 840 10
Base for tube mounting	975 840 90
Base for base mounting	975 812 02
Tube Ø 25 mm, all anodized aluminium	
100 mm long	975 845 10
250 mm long	975 840 25
400 mm long	975 840 40
Anti-twist device	975 815 22
Surface housing IP 65	
for 1 Installation Beacon	975 815 03
for 2 Installation Beacons	975 815 07
for 3 Installation Beacons	975 815 08
for 4 Installation Beacons	975 109 05

TECHNICAL DIAGRAM:

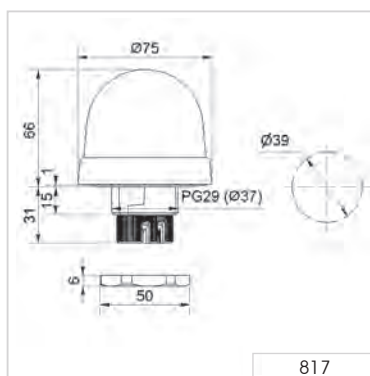

Signalisation index

Xenon Flashing Light 4

