

Micro Installation Beacons - 230/231/232

Your benefits

Despite their size, micro installation beacons from the 230 / 231 / 232 range will provide good all-round visibility. The range includes control panel indicator lights.

- The industry standard for control panels
- Easy to install, even where space is restricted

Typical applications

Signalling faults and statuses

- On small machines and equipment
- In building technology

Installation options

- M22 single-hole mounting including nut
- M20 for direct installation, in safety switches, for example

Features

- Available with a permanent light
- Powerful xenon flash light for increased visibility



Size comparison
Micro/Mini/EvoSIGNAL Mini

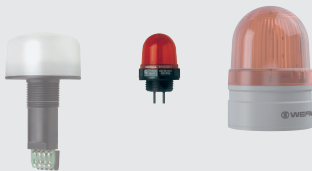

Signalisation index

| Optical | | |
|----------------------|--|---|
| LED Permanent Light | | 2 |
| Xenon Flashing Light | | 4 |

230 LED Installation Beacon



Mainly sideways illumination



The LED Installation Beacon 230 can for example be used in applications with cable-operated switches or limit switch devices

① TECHNICAL SPECIFICATIONS/ORDER SPECIFICATIONS:

| | | | | |
|-----------------------------|--|-------------------|-------------------|-------------------|
| Dimensions (Ø x Height): | 29 mm x 32 mm (Protrusion from panel) | | | |
| Housing: | PC/ABS-Blend | | | |
| Lens: | PC, transparent | | | |
| Connection: | 2 wires, c. 115 mm long | | | |
| Fixing: | Installation mounting for Ø 20.5 mm (M20 x 1.5 mm) | | | |
| Life duration: | Up to 100,000 hrs | | | |
| Seal included in assembly. | | | | |
| Voltage: | 12 V DC | 24 V DC | 115 V AC | 230 V AC |
| Current consumption: | 80 mA | 45 mA | 15 mA | 20 mA |
| red | 230 100 54 | 230 100 55 | 230 100 67 | 230 100 68 |
| yellow | 230 300 54 | 230 300 55 | 230 300 67 | 230 300 68 |
| clear | - | 230 400 55 | - | - |
| Further colours on request. | | | | |

← TECHNICAL DIAGRAM:

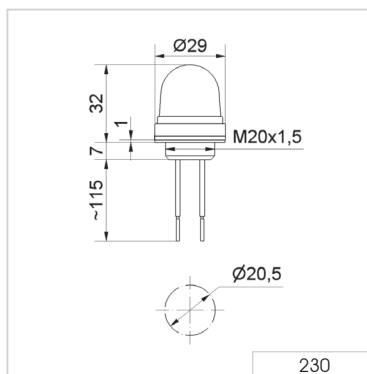

| Signalisation index | |
|---------------------|---|
| LED Permanent Light | 2 |

c UL US

CE

EAC

12 9

IP65

+50°C
-20°C

24 V
PLC



231 LED Installation Beacon



Mainly sideways illumination

① TECHNICAL SPECIFICATIONS/ORDER SPECIFICATIONS:

| | | | | |
|------------------------------------|--|-------------------|-------------------|-------------------|
| Dimensions (Ø x Height): | 29 mm x 32 mm (Protrusion from panel) | | | |
| Housing: | PC/ABS-Blend | | | |
| Lens: | PC, transparent | | | |
| Connection: | 2 wires, c. 105 mm long | | | |
| Fixing: | Installation mounting for Ø 22.5 mm (M22 x 1.5 mm) | | | |
| Life duration: | Up to 100,000 hrs | | | |
| Nut and seal included in assembly. | | | | |
| Voltage: | 12 V DC | 24 V DC | 115 V AC | 230 V AC |
| Current consumption: | 80 mA | 45 mA | 15 mA | 20 mA |
| red | 231 100 54 | 231 100 55 | 231 100 67 | 231 100 68 |
| green | 231 200 54 | 231 200 55 | 231 200 67 | 231 200 68 |
| yellow | 231 300 54 | 231 300 55 | 231 300 67 | 231 300 68 |
| clear | 231 400 54 | 231 400 55 | 231 400 67 | 231 400 68 |
| blue | 231 500 54 | 231 500 55 | 231 500 67 | 231 500 68 |

↔ TECHNICAL DIAGRAM:

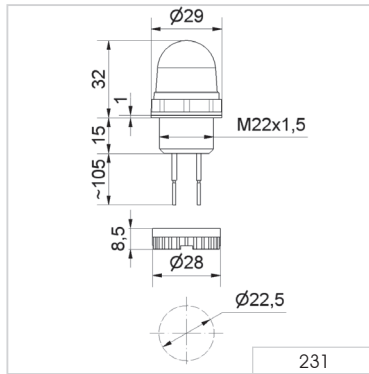

| | |
|---------------------|---|
| Signalisation index | |
| LED Permanent Light | 2 |



24 V

232 Installation Xenon Flashing Beacon



① TECHNICAL SPECIFICATIONS/ORDER SPECIFICATIONS:

| | | |
|------------------------------------|---|-------------------|
| Dimensions (Ø x Height): | 29 mm x 32 mm (Protrusion from panel) | |
| Housing: | PC/ABS-Blend | |
| Lens: | PC, transparent | |
| Connection: | 2 wires, c. 600 mm long | |
| Fixing: | Installation mounting for Ø 22.5 mm (M22 x 1.5 mm) with anti-twist device | |
| Flash frequency: | 1.5 Hz | |
| Flash energy: | 1 Ws | |
| Life duration: | 4 x 10 ⁶ flashes | |
| Nut and seal included in assembly. | | |
| Voltage: | 24 V DC | 230 V AC |
| Current consumption: | 140 mA | 20 mA |
| red | 232 100 55 | 232 100 68 |
| yellow | 232 300 55 | 232 300 68 |

↳ TECHNICAL DIAGRAM:

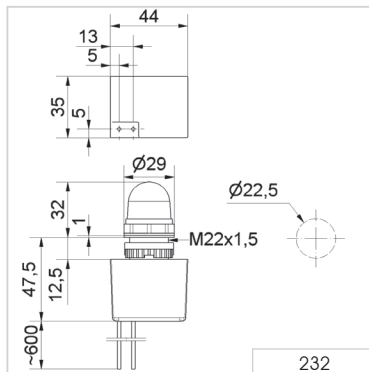

| | |
|----------------------|---|
| Signalisation index | |
| Xenon Flashing Light | 4 |

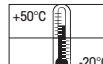

24 V

