

Guardian Line Mini Duty Type: GLM

FEATURES:

PROTECTION UP TO 50 METRES (164 FEET)

The GLM is a compact yet robust die-cast Mini Duty Safety Rope Pull Switch which has been designed to protect short conveyor lengths where protection is required up to 50m using two switches or up to 30m using just a single switch.

The GLM provides a reliable, cost-effective safety solution for conveyor systems and can be enhanced by adding an external mushroom type emergency stop at the switch or a bi-colour LED is available to show switch status from a distance.

The GLM has a choice of 3 or 4 pole contacts to ensure flexibility with all modern control applications.

With the added benefit of rugged internal sealing bellows the GLM is able to undergo high pressure hosing at high temperature.

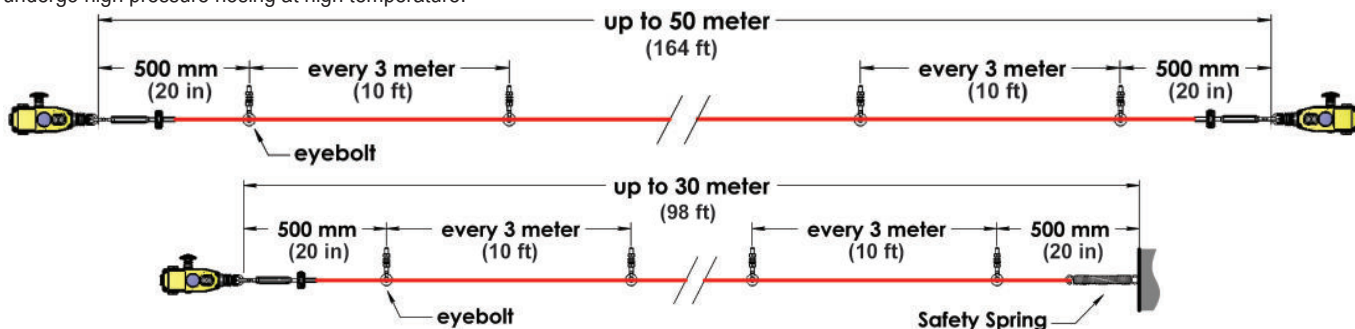

It is important that the first 500mm is not used as part of the active protection coverage. If protection is required in this first 500mm then it is recommended to use switches fitted with a mushroom type E-Stop button. IDEM also recommend when using a Safety Spring that a maximum of one corner pulley is used.

DIMENSIONS:

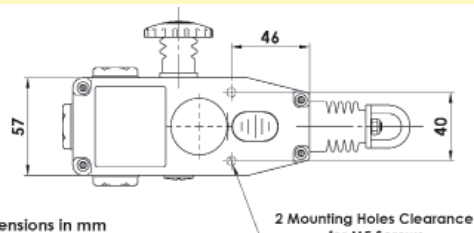
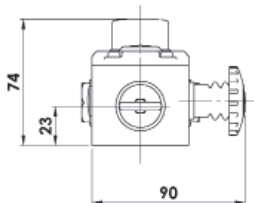
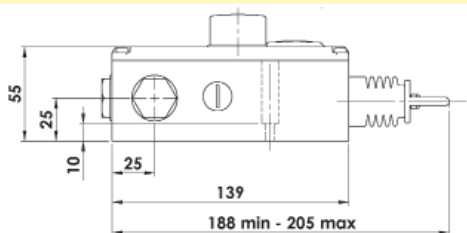

All Dimensions in mm

Standards: EN60947-5-1 EN60947-5-5 EN62061
UL508 ISO13850 ISO13849-1

Safety Classification and Reliability Data:

Mechanical Reliability B10d 1.5 x 10⁶ operations at 100mA load
ISO13849-1 Up to PLe depending upon system architecture
EN62061 Up to SIL3 depending upon system architecture
Safety Data – Annual Usage 8 cycles per hour/24 hours per day/365 days
MTTFd 214 years

Enclosure Material Die Cast (painted yellow)

IP Rating IP67 (NEMA 6)

Rope Span Up to 50m (2 switches) 30m (1 switch)

Rope Tension Device IDEM Tensioner/Gripper (quick fixing)

Rope Type 4.00mm outside dia. Steel inner - PVC sheath

Mounting 4 x M5

Mounting Position Any

Conduit Entries 3 x M20 or 3 x 1/2" NPT (by Sales Number)

Tongue Settings Mounting M5 4.0Nm

Lid T20 Torx M4 1.5Nm

Terminals 1.0Nm

Ambient Temperature -25C +80C

Vibration Resistance 10-500Hz 0.35mm

Shock Resistance 11ms 15g

Tension Force (typical mid setting) 130N

Typical Operating Force (Rope pulled) <125N <300mm deflection

Weight 640g approx.

Contact Type EN60947-5-1 double break type Zb

Snap Action up to 4NC (positive break)

2NO (Auxiliary)

Termination Clamp up to 2.5mm² conductors

Rating Utilisation category AC15 A300

Operational Rating 240V 3A

Thermal Current (Ith) 10A

Rated Insulation Voltage (U) 500V

Withstand Voltage (Uimp) 2500V

Short Circuit Overload Protection Fuse externally 10A(Ff)

SALES NUMBER	CONDUIT	CONTACTS	FITTINGS
143001	M20	2NC 1NO	
143002	1/2" NPT	2NC 1NO	
143003	M20	3NC	
143004	1/2" NPT	3NC	
143005	M20	2NC 1NO	E- Stop
143006	1/2" NPT	2NC 1NO	E- Stop
143007	M20	3NC	E- Stop
143008	1/2" NPT	3NC	E- Stop
143050	M20	3NC 1NO	
143051	1/2" NPT	3NC 1NO	
143052	M20	2NC 2NO	
143053	1/2" NPT	2NC 2NO	
143054	M20	4NC	
143055	1/2" NPT	4NC	
143056	M20	3NC 1NO	E- Stop
143057	1/2" NPT	3NC 1NO	E- Stop
143058	M20	2NC 2NO	E- Stop
143059	1/2" NPT	2NC 2NO	E- Stop
143060	M20	4NC	E- Stop
143061	1/2" NPT	4NC	E- Stop
143062	M20	3NC 1NO	LED
143063	1/2" NPT	3NC 1NO	LED
143064	M20	2NC 2NO	LED
143065	1/2" NPT	2NC 2NO	LED
143066	M20	3NC 1NO	E-Stop & LED
143067	1/2" NPT	3NC 1NO	E-Stop & LED
143068	M20	2NC 2NO	E-Stop & LED
143069	1/2" NPT	2NC 2NO	E-Stop & LED
143009	Replacement Lid		
143010	Replacement Lid/LED		LED
For LED Models add voltage code to Sales Number see below			
Steady Green/Flashing Red			
A - 24Vdc B - 110Vac C - 230Vac			
Steady Green/Steady Red			
AS - 24Vdc BS - 110Vac CS - 230Vac			

For all IDEM switches the normally closed (NC) circuits are closed when the system is tensioned correctly and the switch has been reset.

Gold Plated Contacts available for low power circuits (5V 5mA).
Add GC to Sales Number e.g. 143001-GC

Guardian Line Standard Duty Type: GLS

FEATURES:

PROTECTION UP TO 80 METRES (262 FEET)

The GLS is a General/Standard Duty robust die-cast Safety Rope Pull Switch designed to protect conveyor lengths where protection is required up to 80m using two switches or up to 60m using a single switch.

They provide a reliable general purpose safety solution for conveyors and offer a choice of fittings depending upon the application.

They can be supplied with a mushroom type Emergency Stop button which can be fitted to the side of the switch to offer an extra traditional Emergency Stop function close to the switch, or can be fitted later after installation without any extra wiring.

A bi-colour LED is also available to show switch status from a distance and they have a choice of 3 pole, 4 pole or Explosion Proof contact blocks to ensure flexibility with all modern control applications.

Rugged internal sealing bellows means the GLS can be high pressure hosed and choice of materials makes them suitable for internal or external use.



GLS-FZ: Special low temperature version -40C available.

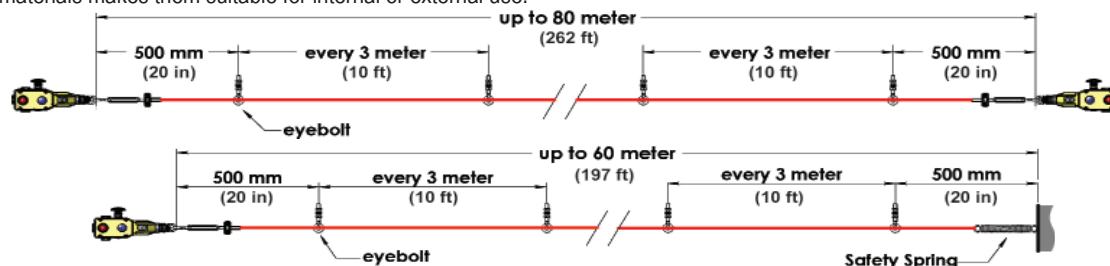

It is important that the first 500mm is not used as part of the active protection coverage. If protection is required in this first 500mm then it is recommended to use switches fitted with a mushroom type E-Stop button. IDEM also recommend when using a Safety Spring that a maximum of one corner pulley is used.

DIMENSIONS:

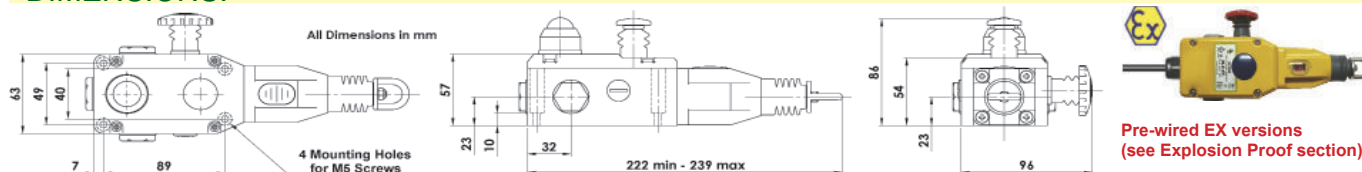

Standards: EN60947-5-1 EN60947-5-5 EN62061
UL508 ISO13850 ISO13849-1

Safety Classification and Reliability Data:

Mechanical Reliability B10d	1.5 x 10 ⁶ operations at 100mA load
ISO13849-1	Up to PLe depending upon system architecture
EN62061	Up to SIL3 depending upon system architecture
Safety Data – Annual Usage	8 cycles per hour/24 hours per day/365 days
	MTTFd 214 years
Enclosure Material	Die Cast (painted yellow)
IP Rating	IP67 (NEMA 6)
Rope Span	Up to 80m (2 switches) 60m (1 switch)
Rope Tension Device	IDEM Tensioner/Gripper (quick fixing)
Rope Type	4.00mm outside dia. Steel inner - PVC sheath
Mounting	4 x M5
Mounting Position	Any
Conduit Entries	3 x M20 or 3 x 1/2" NPT (by Sales Number)
Tongue Settings	Mounting M5 4.0Nm Lid T20 Torx M4 1.5Nm Terminals 1.0Nm
Ambient Temperature	-25C +80C
Vibration Resistance	10-500Hz 0.35mm
Shock Resistance	11ms 15g
Tension Force (typical mid setting)	130N
Typical Operating Force (Rope pulled)	<125N <300mm deflection
Weight	735g approx.
Contact Type	EN60947-5-1 double break type Zb Snap Action up to 4NC (positive break) 2NO (Auxiliary)
Contact Material	Silver
Termination	Clamp up to 2.5mm ² conductors
Rating	Utilisation category AC15
Operational Rating	240V 3A
Thermal Current (Ith)	10A
Rated Insulation Voltage (U)	500V
Withstand Voltage (Uimp)	2500V
Short Circuit Overload Protection	Fuse externally 10A(FF)



Pre-wired EX versions (see Explosion Proof section)

SALES NUMBER	CONDUIT	CONTACTS	FITTINGS
142001	3 x M20	2NC 1NO	
142002	3 x 1/2" NPT	2NC 1NO	
142005	3 x M20	2NC 1NO	LED
142006	3 x 1/2" NPT	2NC 1NO	LED
142009	3 x M20	2NC 1NO	E-Stop
142010	3 x 1/2" NPT	2NC 1NO	E-Stop
142017	3 x M20	2NC 1NO	E-Stop & LED
142018	3 x 1/2" NPT	2NC 1NO	E-Stop & LED
142050	3 x M20	3NC 1NO	
142051	3 x 1/2" NPT	3NC 1NO	
142052	3 x M20	2NC 2NO	
142053	3 x 1/2" NPT	2NC 2NO	
142054	3 x M20	4NC	
142055	3 x 1/2" NPT	4NC	
142056	3 x M20	3NC 1NO	LED
142057	3 x 1/2" NPT	3NC 1NO	LED
142058	3 x M20	2NC 2NO	LED
142059	3 x 1/2" NPT	2NC 2NO	LED
142060	3 x M20	4NC	LED
142061	3 x 1/2" NPT	4NC	LED
142062	3 x M20	3NC 1NO	E-Stop
142063	3 x 1/2" NPT	3NC 1NO	E-Stop
142064	3 x M20	2NC 2NO	E-Stop
142065	3 x 1/2" NPT	2NC 2NO	E-Stop
142066	3 x M20	4NC	E-Stop
142067	3 x 1/2" NPT	4NC	E-Stop
142074	3 x M20	3NC 1NO	E-Stop & LED
142075	3 x 1/2" NPT	3NC 1NO	E-Stop & LED
142076	3 x M20	2NC 2NO	E-Stop & LED
142077	3 x 1/2" NPT	2NC 2NO	E-Stop & LED
142078	3 x M20	4NC	E-Stop & LED
142079	3 x 1/2" NPT	4NC	E-Stop & LED
142026	Replacement Lid		
142027	Replacement Lid/LED		LED

For LED Models add voltage code to Sales Number see below

Steady Green/Flashing Red
A - 24Vdc B - 110Vac C - 230Vac

Steady Green/Steady Red
AS - 24Vdc BS - 110Vac CS - 230Vac

For all IDEM switches the normally closed (NC) circuits are closed when the system is tensioned correctly and the switch has been reset.

Gold Plated Contacts available for low power circuits (5V 5mA).
Add GC to Sales Number e.g. 142001-GC

Guardian Line Heavy Duty Type: GLHD

FEATURES:

PROTECTION UP TO 250 METRES (820 FEET)

The GLHD is a Heavy Duty Safety Rope Pull Switch designed to protect long conveyor lengths. The die-cast housings are robust to survive indoor or outdoor use including washdown (IP67 rating). Lengths over 2 Km can be achieved with less than 20 switches.

A bi-colour LED ensures switch status can be seen easily from a distance. They have 4NC 2NO contacts to ensure flexibility with all modern control applications and optional Explosion Proof contact blocks are available.

Shorter rope spans up to 200m can be achieved by using just one switch therefore making a cost effective solution and also reducing electrical wiring runs.



Low temperature version -40C available GLHD-FZ

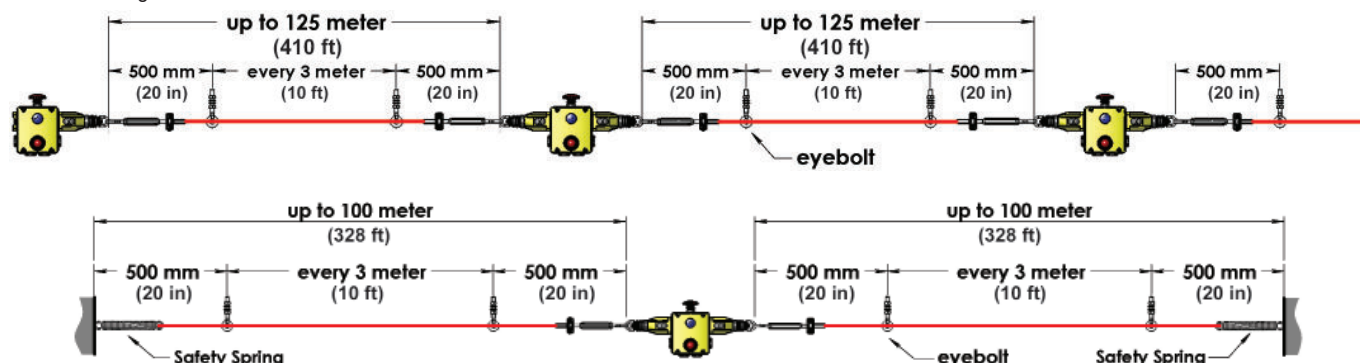

It is important that the first 500mm is not used as part of the active protection coverage. If protection is required in this first 500mm then it is recommended to use switches fitted with a mushroom type E-Stop button. IDEM also recommend when using a Safety Spring that a maximum of one corner pulley is used.

DIMENSIONS:

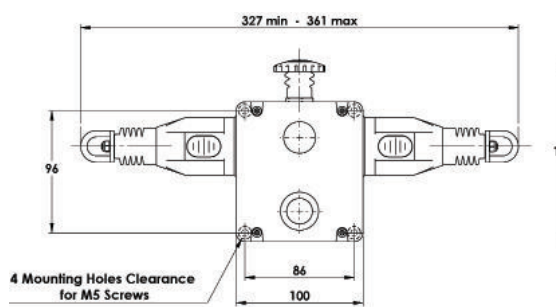

All Dimensions in mm

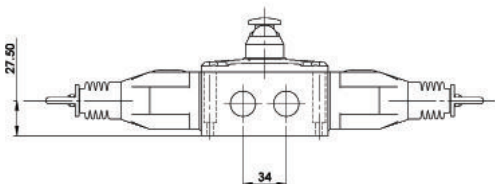

Pre-wired EX versions
(see Explosion Proof section)

Standards: EN60947-5-1 EN60947-5-5 EN62061
UL508 ISO13850 ISO13849-1

Safety Classification and Reliability Data:

Mechanical Reliability B10d	1.5 x 10 ⁶ operations at 100mA load
ISO13849-1	Up to PLe depending upon system architecture
EN62061	Up to SIL3 depending upon system architecture
Safety Data – Annual Usage	8 cycles per hour/24 hours per day/365 days
MTTf	214 years
Enclosure/Cover Material	Die-Cast (painted yellow)
IP Rating	IP67 (NEMA 6)
Rope Span	250m Dual Head
Rope Tension Device	IDEM Tensioner/Gripper (quick fixing)
Rope Type	4.00mm outside dia. Steel inner - PVC sheath
Mounting	4 x M5
Mounting Position	Any
Conduit Entries	4 x M20 or 4 x 1/2" NPT (by Sales Number)
Tongue Settings	Mounting M5 4.0Nm Lid T20 Torx M4 1.5Nm Terminals 1.0Nm
Ambient Temperature	-25C +80C
Vibration Resistance	10-500Hz 0.35mm
Shock Resistance	11ms 15g
Tension Force (typical mid setting)	130N
Typical Operating Force (Rope pulled)	<125N <300mm deflection
Mechanical Life	1,000,000 operations
Weight	1350g approx.
Contact Type	EN60947-5-1 double break type Zb Snap Action up to 4NC (positive break) 2NO (Auxiliary)
Contact Material	Silver
Termination	Clamp up to 2.5mm ² conductors
Rating	Utilisation category AC15 A300
Operational Rating	240V 3A
Thermal Current (Ith)	10A
Rated Insulation Voltage (U)	500V
Withstand Voltage (Uimp)	2500V
Short Circuit Overload Protection	Fuse externally 10A(FF)

SALES NUMBER	TYPE	CONDUIT	CONTACTS	FITTINGS
141001	GLHD	4 x M20	4NC 2NO	LED & E-Stop
141002	GLHD	4 x 1/2" NPT	4NC 2NO	LED & E-Stop
141029	GLHD	4 x M20	4NC 2NO	LED
141030	GLHD	4 x 1/2" NPT	4NC 2NO	LED
141039	GLHD	4 x M20	4NC 2NO	E-Stop
141040	GLHD	4 x 1/2" NPT	4NC 2NO	E-Stop
141041	GLHD	4 x M20	4NC 2NO	
141042	GLHD	4 x 1/2" NPT	4NC 2NO	
141012	GLH		Replacement Lid	
141013	GLH		Replacement Lid with LED	
For LED Models add voltage code to Sales Number see below				
Steady Green/Flashing Red				
A - 24Vdc B - 110Vac C - 230Vac				
Steady Green/Steady Red				
AS - 24Vdc BS - 110Vac CS - 230Vac				

Gold Plated Contacts available for low power circuits (5V 5mA).
Add GC to Sales Number e.g. 141001-A-GC

For all IDEM switches the normally closed (NC) circuits are closed when the system is tensioned correctly and the switch has been reset.

Guardian Line Heavy Duty Type: GLHL & GLHR

FEATURES:

PROTECTION UP TO 125 METRES (410 FEET)

The GLHL/R is a robust die-cast Heavy Duty Safety Rope Pull Switch designed to protect long conveyor lengths where protection is required up to 125m using two switches or up to 100m using a single switch. The die-cast housings are robust to survive indoor or outdoor use.

A bi-colour LED ensures switch status can be seen easily from a distance. They have 4NC 2NO contacts to ensure flexibility with all modern control applications and optional Explosion Proof contact blocks are available.

They can be used to complement the GLHD versions at each end of the rope span.



GLHL (Left Hand)

GLHR (Right Hand)

Low temperature versions -40C available GLHL-FZ and GLHR-FZ

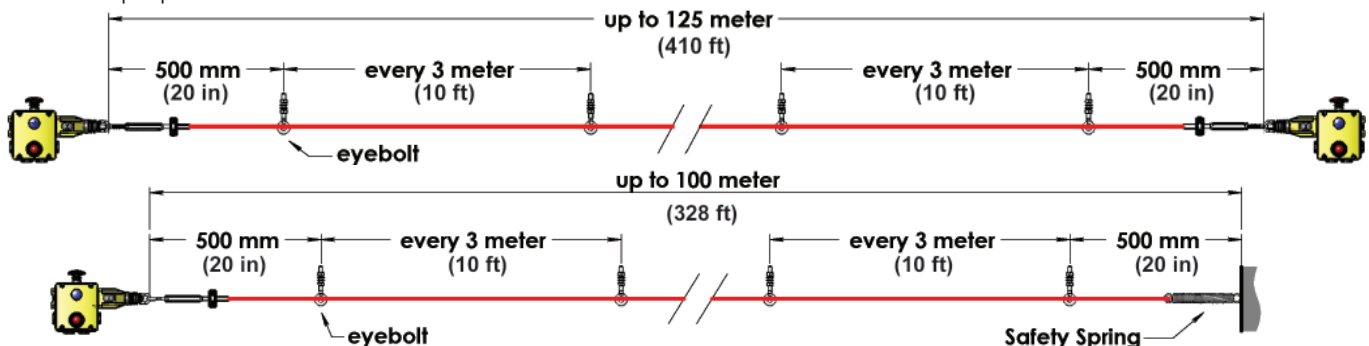

It is important that the first 500mm is not used as part of the active protection coverage. If protection is required in this first 500mm then it is recommended to use switches fitted with a mushroom type E-Stop button. IDEM also recommend when using a Safety Spring that a maximum of one corner pulley is used.

DIMENSIONS:

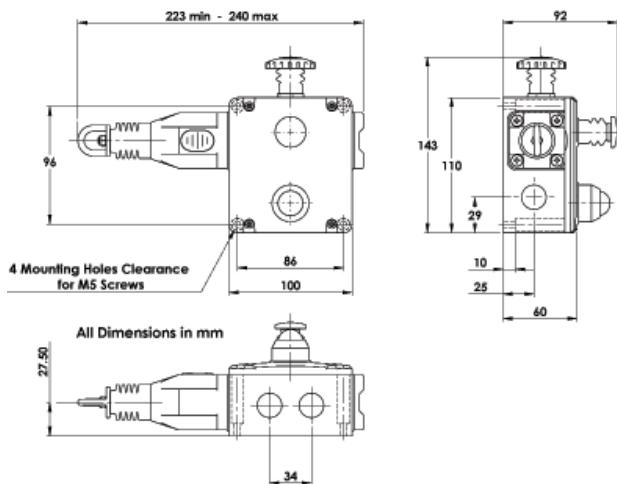

Pre-wired EX versions
(see Explosion Proof section)

Standards: EN60947-5-1 EN60947-5-5 EN62061
UL508 ISO13850 ISO13849-1

Safety Classification and Reliability Data:

Mechanical Reliability B10d	1.5 x 10 ⁶ operations at 100mA load
ISO13849-1	Up to PLe depending upon system architecture
EN62061	Up to SIL3 depending upon system architecture
Safety Data – Annual Usage	8 cycles per hour/24 hours per day/365 days
PFHd	<1.0 x 10 ⁻⁷
Proof Test Interval (Life)	21 years
MTTFd	214 years
Enclosure/Cover Material	Die-Cast (painted yellow)
IP Rating	IP67 (NEMA 6)
Rope Span	125m
Rope Tension Device	IDEM Tensioner/Gripper (quick fixing)
Rope Type	4.00mm outside dia. Steel inner - PVC sheath
Mounting	4 x M5
Mounting Position	Any
Conduit Entries	4 x M20 or 4 x 1/2" NPT (by Sales Number)
Tongue Settings	Mounting M5 4.0Nm Lid T20 Torx M4 1.5Nm Terminals 1.0Nm
Ambient Temperature	-25C +80C
Vibration Resistance	10-500Hz 0.35mm
Shock Resistance	11ms 15g
Tension Force (typical mid setting)	130N
Typical Operating Force (Rope pulled)	<125N <300mm deflection
Weight	1030g approx.
Contact Type	EN60947-5-1 double break type Zb Snap Action up to 4NC (positive break) 2NO (Auxiliary)
Contact Material	Silver
Termination	Clamp up to 2.5mm ² conductors
Rating	Utilisation category AC15 A300
Operational Rating	240V 3A
Thermal Current (Ith)	10A
Rated Insulation Voltage (U)	500V
Withstand Voltage (Uimp)	2500V
Short Circuit Overload Protection	Fuse externally 10A(FF)

SALES NUMBER	TYPE	CONDUIT	CONTACTS	FITTINGS
141005	GLHL	4 x M20	4NC 2NO	LED & E-Stop
141006	GLHL	4 x 1/2" NPT	4NC 2NO	LED & E-Stop
141053	GLHL	4 x M20	4NC 2NO	LED
141055	GLHL	4 x 1/2" NPT	4NC 2NO	LED
141051	GLHL	4 x M20	4NC 2NO	E-Stop
141035	GLHL	4 x 1/2" NPT	4NC 2NO	E-Stop
141037	GLHL	4 x M20	4NC 2NO	
141057	GLHL	4 x 1/2" NPT	4NC 2NO	
141009	GLHR	4 x M20	4NC 2NO	LED & E-Stop
141010	GLHR	4 x 1/2" NPT	4NC 2NO	LED & E-Stop
141054	GLHR	4 x M20	4NC 2NO	LED
141056	GLHR	4 x 1/2" NPT	4NC 2NO	LED
141052	GLHR	4 x M20	4NC 2NO	E-Stop
141036	GLHR	4 x 1/2" NPT	4NC 2NO	E-Stop
141038	GLHR	4 x M20	4NC 2NO	
141058	GLHR	4 x 1/2" NPT	4NC 2NO	
141012	GLH		Replacement Lid	
141013	GLH		Replacement Lid with LED	

For LED Models add voltage code to Sales Number see below

Steady Green/Flashing Red
A - 24Vdc B - 110Vac C - 230Vac

Steady Green/Steady Red
AS - 24Vdc BS - 110Vac CS - 230Vac

Gold Plated Contacts available for low power circuits (5V 5mA).
Add GC to Sales Number e.g. 141005-A-GC

For all IDEM switches the normally closed (NC) circuits are closed when the system is tensioned correctly and the switch has been reset.

Grab Wire Auto-Reset Trip Switch Type: GLS-AR

FEATURES:

Grab Wire Auto-Reset Rope Switches are mounted on machines and sections of plant conveyors to initiate a momentary control signal command from any point along the installed rope length.

Pulling the rope causes instant tripping of the control circuit contacts.

Ideal for normal stop circuits where manual resetting of the switch is not required. **This switch is not an emergency stop, it is a "trip" switch with automatic reset.**

Rope Pull operated Auto Reset- Stop Switch



GLS-AR

APPLICATION:

The switches have a positive mechanical linkage between the switch contacts and the wire rope as per EN60947-5-1. The switches are brought into the operational condition by pre-tensioning the rope by use of a tensioner device which clamps the rope and then hooks to the switch eyebolts. Correct tension can be observed by viewing the tension indicator on the switch housing. Once tensioned the switch contact blocks are set to the operational condition. i.e. Signal Contacts Closed - Auxiliary Contacts Open.

All of the switches have wire breakage monitoring. On pulling or breakage (loss of tension) of the rope, the normally closed Signal Contacts are opened and the Auxiliary Contacts are closed. The switches will be returned to the operational condition as soon as the rope returns to the set position.

Explosion Proof version:
Zones 1,2,21,22



DIMENSIONS:

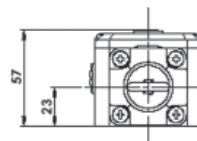
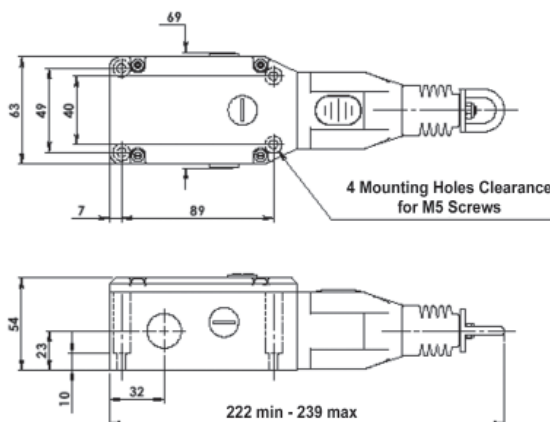

Mechanical Features:

Enclosure/Cover Material	Die-Cast (painted yellow)
IP Rating	IP67
Rope Span	Up to 80m
Rope Tension Device	IDEM Tensioner/Gripper (quick fixing)
Rope Type	4.00mm outside dia. Steel inner - PVC sheath
Mounting	4 x M5
Mounting Position	Any
Conduit Entries	3 x M20 or 3 x 1/2" NPT (by Sales Number)
Tongue Settings	Mounting M5 4.0Nm Lid T20 Torx M4 1.5Nm Terminals 1.0Nm
Ambient Temperature	-25C +80C
Vibration Resistance	10-500Hz 0.35mm
Shock Resistance	11ms 15g
Tension Force (typical mid setting)	130N
Typical Operating Force (Rope pulled)	<125N <300mm deflection
Mechanical Life	1,000,000 operations
Approx.Weight	760g

Electrical Features:

Contact Type	EN60947-5-1 double break type Zb Snap Action up to 2NC + 1NO (Auxiliary)
Contact Material	Silver
Termination	Clamp up to 2.5mm ² conductors
Rating	Utilisation category AC15
Operational Rating	240V 3A
Thermal Current (Ith)	10A
Rated Insulation Voltage (U)	500V
Withstand Voltage (Uimp)	2500V
Short Circuit Overload Protection	Fuse externally 10A(FF)

Standards: EN60947-5-1 EN60947-5-5 EN62061
UL508 ISO13849-1

Safety Classification and

Reliability Data:
Mechanical Reliability B10d 1.5 x 10⁶ operations at 100mA load

ATEX Classification (EX Versions) Exd IIC T6 (-20 ≤ Ta ≤ +60C) Gb
Ex tb IIIC T85C (-20 ≤ Ta ≤ +60C) Db
Rated Voltage 250Vac
Rated Current 4Aac
Cable Length 3m pre-wired (EX versions)

SALES NUMBER	TYPE	CONDUIT	CONTACTS	FITTINGS
142498	GLS-AR	3 x M20	2NC 1NO	
142499	GLS-AR	3 x 1/2" NPT	2NC 1NO	
142496	GLS-AR	EX	1NC 1NO	Pre-Wired 3m
142497	GLS-AR	EX	2NC	Pre-Wired 3m

For all IDEM switches the normally closed (NC) circuits are closed when the system is tensioned correctly and the switch has been reset.

Gold Plated Contacts available for low power circuits (5V 5mA).
Add GC to Sales Number e.g. 142498-GC

Grab Wire Auto-Reset Trip Switch Type: GLS-SS-AR

FEATURES:

Grab Wire Auto-Reset Rope Switches are mounted on machines and sections of plant conveyors to initiate a momentary control signal command from any point along the installed rope length.

Pulling the rope causes instant tripping of the control circuit contacts.

Ideal for normal stop circuits where manual resetting of the switch is not required. **This switch is not an emergency stop, it is a "trip" switch with automatic reset.**

Rope Pull operated Auto Reset- Stop Switch



GLS-SS-AR

APPLICATION:

The switches have a positive mechanical linkage between the switch contacts and the wire rope as per EN60947-5-1. The switches are brought into the operational condition by pre-tensioning the rope by use of a tensioner device which clamps the rope and then hooks to the switch eyebolts. Correct tension can be observed by viewing the tension indicator on the switch housing. Once tensioned the switch contact blocks are set to the operational condition. i.e. Signal Contacts Closed - Auxiliary Contacts Open.

All of the switches have wire breakage monitoring. On pulling or breakage (loss of tension) of the rope, the normally closed Signal Contacts are opened and the Auxiliary Contacts are closed. The switches will be returned to the operational condition as soon as the rope returns to the set position.

Explosion Proof version:
Zones 1,2,21,22



DIMENSIONS:

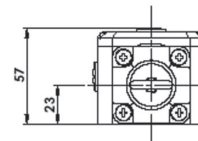
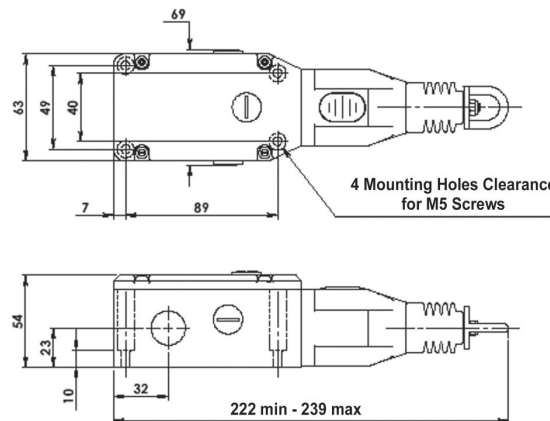

Mechanical Features:

Enclosure/Cover Material	Die-Cast (painted yellow) or Stainless Steel 316
IP Rating	IP69K
Rope Span	Up to 80m
Rope Tension Device	IDEM Tensioner/Gripper (quick fixing)
Rope Type	4.00mm outside dia. Steel inner - PVC sheath
Mounting	4 x M5
Mounting Position	Any
Conduit Entries	3 x M20 or 3 x 1/2" NPT (by Sales Number)
Tongue Settings	Mounting M5 4.0Nm Lid T20 Torx M4 1.5Nm Terminals 1.0Nm

Ambient Temperature	-25C +80C
Vibration Resistance	10-500Hz 0.35mm
Shock Resistance	11ms 15g

Tension Force (typical mid setting)	130N
Typical Operating Force (Rope pulled)	<125N <300mm deflection
Mechanical Life	1,000,000 operations
Approx.Weight	1780g

Electrical Features:

Contact Type	EN60947-5-1 double break type Zb Snap Action up to 2NC + 1NO (Auxiliary)
Contact Material	Silver
Termination	Clamp up to 2.5mm ² conductors
Rating	Utilisation category AC15
Operational Rating	240V 3A
Thermal Current (Ith)	10A
Rated Insulation Voltage (U)	500V
Withstand Voltage (Uimp)	2500V
Short Circuit Overload Protection	Fuse externally 10A(FF)

Standards: EN60947-5-1 EN60947-5-5 EN62061
UL508 ISO13849-1

Safety Classification and Reliability Data:

Mechanical Reliability B10d 1.5 x 10⁶ operations at 100mA load

ATEX Classification (EX Versions)

Exd IIC T6 (-20 ≤ Ta ≤ +60C)	Gb
Ex tb IIIC T85C (-20 ≤ Ta ≤ +60C)	Db
Rated Voltage	250Vac
Rated Current	4Aac
Cable Length	3m pre-wired (EX versions)

SALES NUMBER	TYPE	CONDUIT	CONTACTS	FITTINGS
144498	GLS-SS-AR	3 x M20	2NC 1NO	
144499	GLS-SS-AR	3 x 1/2" NPT	2NC 1NO	
144496	GLS-SS-AR	EX	1NC 1NO	Pre-Wired 3m
144497	GLS-SS-AR	EX	2NC	Pre-Wired 3m

For all IDEM switches the normally closed (NC) circuits are closed when the system is tensioned correctly and the switch has been reset.

Gold Plated Contacts available for low power circuits (5V 5mA).
Add GC to Sales Number e.g. 142498-GC